



Sunseeker

RANGE OVERVIEW



THE SUNSEEKER RANGE SETS NEW STANDARDS AND BENCHMARKS IN THE YACHT INDUSTRY. FROM MAJESTIC YACHTS AND SUPERYACHTS THROUGH TO THE TIMELESS PERFORMANCE , PREDATOR, SPORT YACHT, MANHATTAN AND OCEAN RANGES, EACH SUNSEEKER IS THE PURSUIT OF PERFECTION.

CONTENTS

| | |
|-------------------------------|-----|
| HERITAGE..... | 4 |
| INNOVATION..... | 6 |
| AWARDS AND ACHIEVEMENTS | 8 |
| PERFORMANCE | |
| HAWK 38 | 11 |
| SUPERHAWK 55..... | 21 |
| PREDATOR | |
| PREDATOR 55 | 32 |
| PREDATOR 65..... | 44 |
| PREDATOR 75 | 56 |
| SPORT YACHT | |
| 55 SPORT YACHT..... | 67 |
| 65 SPORT YACHT | 78 |
| 75 SPORT YACHT | 91 |
| MANHATTAN | |
| MANHATTAN 55 | 101 |
| MANHATTAN 68 | 113 |
| YACHT | |
| 76 YACHT..... | 126 |
| 88 YACHT | 138 |
| 95 YACHT..... | 150 |
| 100 YACHT | 162 |
| OCEAN | |
| OCEAN 156..... | 175 |
| 90 OCEAN..... | 187 |
| OCEAN 182 | 199 |
| OCEAN 460..... | 210 |
| 50M OCEAN..... | 220 |
| SUPERYACHT | |
| 116 YACHT | 231 |
| 131 YACHT..... | 243 |

HERITAGE

Sunseeker is the world's leading brand for luxury performance motor yachts. Originally named Poole Power Boats, the company was founded by brothers Robert and John Braithwaite in 1969. The company changed its name to Sunseeker International in 1985 and has since become a global icon, with every Sunseeker the result of an uncompromising and unmatched approach to design, craftsmanship and performance.



SOVEREIGN 20



HERITAGE

We have continued to develop and perfect our yachts. Technical and design excellence have always been fundamental to the very fabric of our being.



SUPERHAWK 34



105 YACHT

A man with dark hair, wearing a white short-sleeved polo shirt and a watch on his left wrist, is using a white VR headset and two white motion controllers. He is standing in front of a large, detailed architectural drawing of a yacht hull, which is projected onto a wall or screen. The drawing shows the complex lines and structure of the yacht's hull, including the stern and side sections. The man is looking down at the controllers, appearing to be in the middle of a virtual reality experience.

INNOVATION

Our Centre of Excellence for Design and Technology is a central hub that vertically integrates each conceptual, design and build phase of our yachts. We are proud to lead the industry in technical innovation and smart design solutions.



INNOVATION

In an era of digital production and automated assembly, we stay committed to creating hand-built, hand-finished boats.

AWARDS AND ACHIEVEMENTS

2023

MOTOR BOAT AWARDS

90 Ocean – Best Custom Yacht

2022

THE ENGAGE MARKETING AWARDS

Best Use of Innovation in Customer Engagement

METSTRADE BOAT BUILDER AWARDS

Best Apprenticeship and Training Scheme

WORLD YACHT TROPHIES

100 Yacht – Best Exterior Design

MOTOR BOAT AWARDS

65 Sport Yacht – Sports Cruisers over 45ft

BOAT DESIGN & INNOVATION AWARDS

90 Ocean Sunseeker X-TEND™ – Innovation of the Year

ROBB REPORT BEST OF THE BEST AWARDS

65 Sport Yacht SkyHelm™

2021

WORLD YACHT TROPHIES 2021

65 Sport Yacht – Best Exterior Design, 64' – 80'

88 Yacht – Best Exterior Design, 80' – 98'

90 Ocean – Best layout, 80' – 98'

IBI BOAT BUILDER AWARDS

65 Sport Yacht SkyHelm™ – Innovative On-Board Design Solution

2020

MOTOR BOAT AWARDS

76 Yacht – 'Flybridges over 60ft'

2019

MOTOR BOAT AWARDS

Predator 50 – 'Best Sports cruiser over 45ft'

ASIA BOATING AWARDS

74 Sport Yacht – 'Best Sports Cruiser – above 55 Feet'

CHRISTOFLE YACHT STYLE AWARDS

74 Sport Yacht – Best Motor Yacht in Asia, 20-25m

2018

CHRISTOFLE YACHT STYLE AWARDS

76 Yacht – Best International Motor Yacht 15-24m

MOTOR BOAT OF THE YEAR AWARDS

Manhattan 66 – Best Flybridge Over 60ft

ASIA BOATING AWARDS

Predator 50 – Best Sports Cruiser up to 55ft

2017

MOTOR BOAT OF THE YEAR AWARDS

Manhattan 52 – Best Flybridge up to 55ft

ASIA PACIFIC BOATING AWARDS

131 Yacht – Best Yacht Design

BOAT BUILDER AWARDS

Sunseeker 'BEACH CLUB' concept

– Most Innovative On-Board Design Solution

BOAT BUILDER AWARDS

Best Apprenticeship and Training Scheme

2016

MOTOR BOAT OF THE YEAR AWARDS

Predator 57 – Sports Cruiser over 45ft

ASIA BOATING AWARDS

155 Yacht – Best Production Motor Yacht

WALPOLE AWARDS

Champion of British Luxury Manufacturing

BOAT BUILDER AWARDS

Robert Braithwaite – Lifetime Achievement Award

2015

ASIA BOATING AWARDS

Best Brand Presence

2014

WORLD YACHT TROPHIES

101 Sport Yacht – 'Best Exterior Design'

ASIA BOATING AWARDS

Predator 80 – Best Worldwide Production

Motor Yacht 15M-24M

WORLD SUPERYACHT AWARDS

40 Metre Yacht 'Sea Raider V' – Finalist

2013

ASIA BOATING AWARDS

Best Brand Presence

MOTOR BOAT OF THE YEAR AWARDS

28 Metre Yacht – 'Best Custom Yacht'

2012

MOTOR BOAT OF THE YEAR AWARDS

Manhattan 63 – 'Best Flybridge above 55ft'

ROBB REPORT CHINA

'Best of the Best' 28 Metre Yacht

ASIA BOATING AWARDS

28 Metre Yacht – Best Production

Motor Yacht 24M-40M

WORLD SUPERYACHT AWARDS

Predator 130 'Never Say Never' – Finalist

2011

ASIA BOAT AWARDS

Best Brand Presence in Asia

EUROPEAN CEO CORPORATE LIFESTYLE AWARDS

Best Luxury Brand

SHOWBOATS DESIGN AWARDS FLORIDA

Naval Architecture Motoryacht 'Evil Zana'

Predator 130

2010

WORLD SUPERYACHT AWARDS

Predator 130 'Evil Zana' – Finalist

QUINTESENTIALLY AWARDS

Yacht Charter of the Year

SYDNEY BOAT SHOW

Boating Industry Association of NSW

– Best Marina Display

SYDNEY BOAT SHOW

Boating Industry Association of NSW

– Best Overall Display

ASIA BOATING AWARDS

Predator 60 – Best Production Motoryacht 51 to 80 feet

2009

SYDNEY BOAT SHOW

Display of Excellence

CROATIA BOAT SHOW

Predator 92 Sport – Best in Class

CROATIA BOAT SHOW

30 Metre Yacht – Best in Class

CROATIA BOAT SHOW

Best Boat Show Stand

AWARDS AND ACHIEVEMENTS

2008

MOTOR BOAT OF THE YEAR AWARDS
Manhattan 60

2007

EUROPEAN POWERBOAT OF THE YEAR
Superhawk 43

ASIA PACIFIC BOATING AWARDS
90 Yacht, Best of the Best

MODERN BOATING MAGAZINE
Portofino 47, Imported Powerboat of the Year

**AUSTRALIAN MARINE INDUSTRIES
FEDERATION AWARDS**
Predator 62, Imported Powerboat of the Year

NOMINATED BY THE SUPERYACHT SOCIETY
37 Metre Yacht 'The Snapper'

QUEEN'S AWARD FOR ENTERPRISE
International Trade

ROBERT BRAITHWAITE IS HONOURED WITH CBE
The Queen's Birthday Honours List

2006

NOMINATED FOR THREE SUPERYACHT AWARDS
Predator 108 'SHIVER'

2005

**AUSTRALIAN MARINE INDUSTRIES
FEDERATION AWARDS**
75 Yacht, Non-Trailable Boat Award

**AUSTRALIAN MARINE INDUSTRIES
FEDERATION AWARDS**
Portofino 46, Commendation

**MODERN BOATING,
POWER BOAT OF THE YEAR AWARDS**
Predator 68, Imported Powerboat of the Year

BOATS.COM MARINE INDUSTRY WEB AWARDS
Manufacturers Category for www.sunseeker.com

2004

SYDNEY BOAT SHOW
Best Overall Display

SYDNEY BOAT SHOW
Best Marina Display

2003

AUSTRALIAN MARINE AWARDS
Manhattan 56, Award for Excellence

AUSTRALIAN MARINE AWARDS
Predator 68, Best Imported Non-Trailable Yacht

2002

ENTREPRENEUR OF THE YEAR AWARD
Robert Braithwaite MBE

2001

BEST POWER DESIGN AWARD
105 Yacht, The Superyacht Society

BEST POWER INTERIOR AWARD
105 Yacht, The Superyacht Society

PRESIDENT'S AWARD
Southern California Marine Association

2000

QUEEN'S AWARD FOR ENTERPRISE
Continuous Innovation and Development

THE TIMES EXPORTER OF THE YEAR
Times Export Awards

ROBB REPORT AWARD
Best of the Best, Boating and Sailing

1999

ROBB REPORT AWARD
Best of the Best, Boating and Sailing

MOTORBOAT OF THE YEAR
Predator 75, BT British Nautical Awards

1998

SUPERYACHT DESIGN AWARD
Manhattan 74, Superyacht Design Awards

EDITOR IN CHIEF AWARDS
Yachts Magazine

1997

LIFETIME ACHIEVEMENT AWARD
Robert Braithwaite MBE, RYA Awards

1996

MOTORCRUISER OF THE YEAR AWARD
RYA British Nautical Awards

EXPORTER OF THE YEAR AWARD
DCCI Export Awards

1995

BOAT BUILDER OF THE YEAR AWARD
RYA/BMIF British Nautical Awards

1994

QUEEN'S AWARD FOR EXPORT ACHIEVEMENT
Queen's Awards for Industry

1992

BEST IN THE WORLD AWARD
Renegade 60, Boating Magazine

**ROBERT BRAITHWAITE IS HONOURED
WITH MBE**
The Queen's Birthday Honours List

1990

EXPORTER OF THE YEAR
SW International Business Awards

1989

QUEEN'S AWARD FOR EXPORT ACHIEVEMENT
Queen's Awards for Industry

1987

QUEEN'S AWARD FOR EXPORT ACHIEVEMENT
Queen's Awards for Industry

A close-up, low-angle shot of a powerful ocean wave crashing. The water is a deep, vibrant blue, and the crest of the wave is breaking into a thick, white foam. The motion is captured with a slight blur, emphasizing the energy and power of the wave. The word "PERFORMANCE" is centered horizontally across the middle of the image, overlaid on the white foam of the wave.

PERFORMANCE



HAWK 38



H A W K 38

The Hawk 38 has the heart of a racer and a soul born of Sunseeker's performance roots: cutting-edge technology and incredible design. With twin Mercury 400R outboards paired to Mercury Racing Digital Zero Effort throttles, it delivers a thunderous 62 knots with safe, predictable handling and unparalleled agility.





PRINCIPAL CHARACTERISTICS

LENGTH OVERALL
11.85M / 38' 11"

BEAM
3.01M / 9' 9"

DISPLACEMENT
5,000 KG / 11,020 LB

FUEL CAPACITY
700 LITRES / 185 US GAL.

FRESH WATER CAPACITY
100 LITRES / 26 US GAL.

BLACK WATER CAPACITY
70 LITRES / 18 US GAL.

ENGINE OPTIONS
2 X MERCURY UP TO 800 PS

MAXIMUM SPEED
UP TO 62 KNOTS

RANGE @ 21 KNOTS
UP TO 200 NAUTICAL MILES

DRIVES
OUTBOARDS













HAWK 38 GENERAL ARRANGEMENTS



PROFILE AND EXTERIOR PLAN



S U P E R H A W K 5 5



SUPERHAWK 55

The Superhawk 55 is an open day boat set to thrill with sleek design, exquisite detailing and exciting innovations. An incredibly lightweight performance yacht, she is powered by twin Volvo Penta D11 - IPS 950 engines, capable of a thrilling 38 knots with exceptional agility.





PRINCIPAL CHARACTERISTICS

LENGTH OVERALL
17.13M / 56' 2"

BEAM
4.93M / 16' 2"

DRAFT
1.43 M / 4' 8"

DISPLACEMENT
26,100 KG / 57,500 LB

FUEL CAPACITY
1,800 LITRES / 476 US GAL.

FRESH WATER CAPACITY
430 LITRES / 114 US GAL.

BLACK WATER CAPACITY
150 LITRES / 39 US GAL.

ACCOMMODATION
UP TO 4 GUESTS

ENGINE OPTIONS
VOLVO PENTA IPS UP TO 1,450 PS

MAXIMUM SPEED
UP TO 38 KNOTS

DRIVES
PODS



SUPERHAWK

55









SUPERHAWK 55

GENERAL ARRANGEMENTS

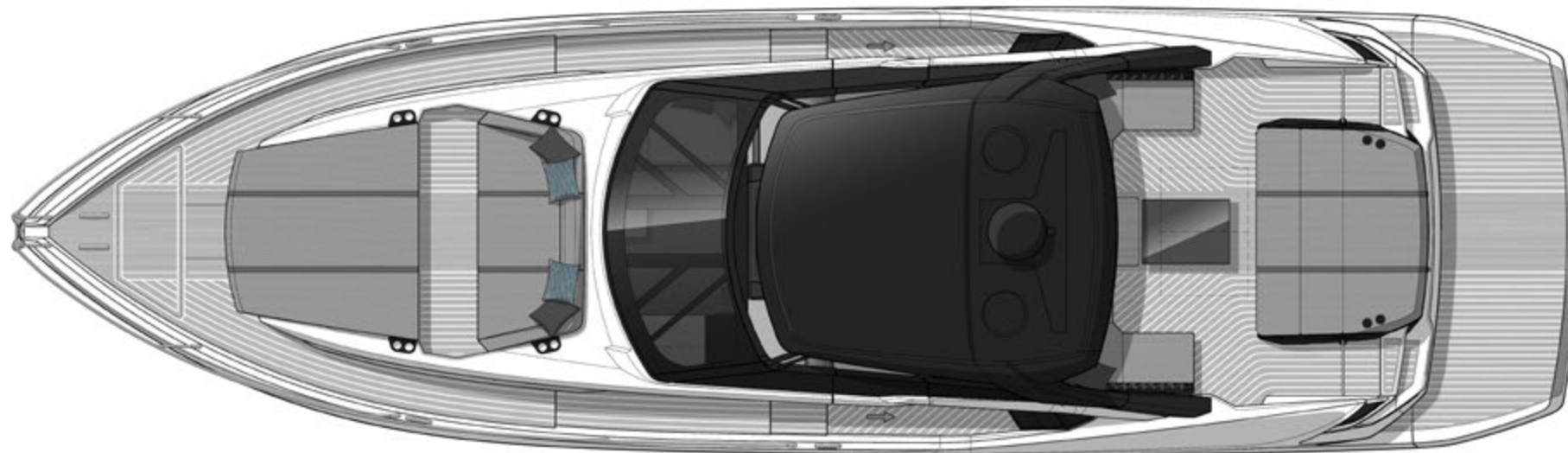

PROFILE AND EXTERIOR PLAN
SHOWN WITH OPTIONAL SIDE DECKING

SUPERHAWK 55

GENERAL ARRANGEMENTS

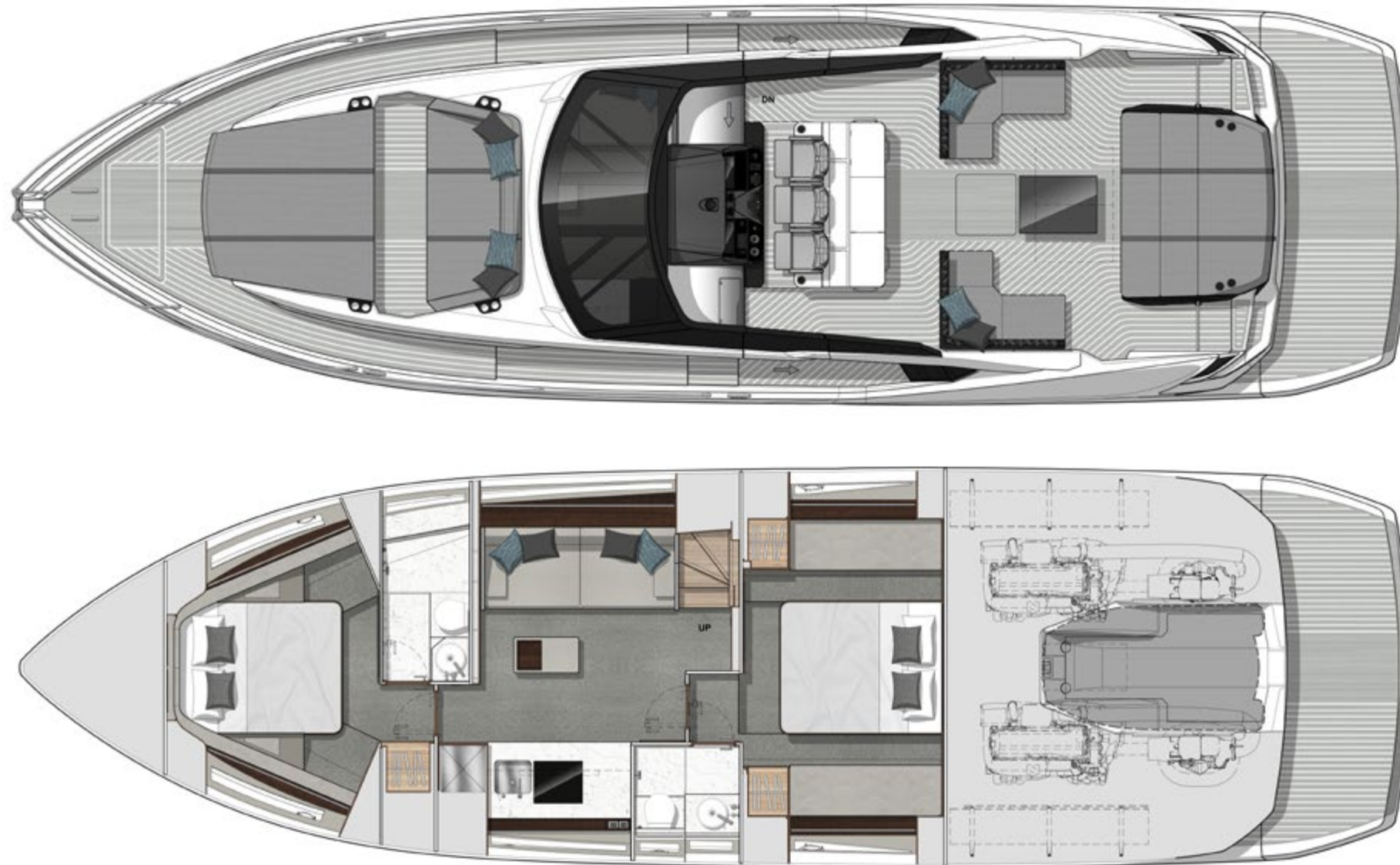

MAIN AND LOWER DECK
SHOWN WITH OPTIONAL TENDER



PREDATOR



PREDATOR 55



PREDATOR 55

Born to perform. Style and functionality work cohesively to define a yacht built for driving and enjoyment.





PRINCIPAL CHARACTERISTICS

LENGTH OVERALL
17.13M / 56' 2"

BEAM
4.93M / 16' 2"

DRAFT
1.43 M / 4' 8"

FUEL CAPACITY
1,800 LITRES / 476 US GAL.

FRESH WATER CAPACITY
430 LITRES / 114 US GAL.

BLACK WATER CAPACITY
150 LITRES / 39 US GAL.

ACCOMMODATION
UP TO 6 GUESTS

ENGINE OPTIONS
VOLVO PENTA IPS UP TO 1,450 PS

MAXIMUM SPEED
UP TO 38 KNOTS

DRIVES
PODS









PREDATOR 55

GENERAL ARRANGEMENTS

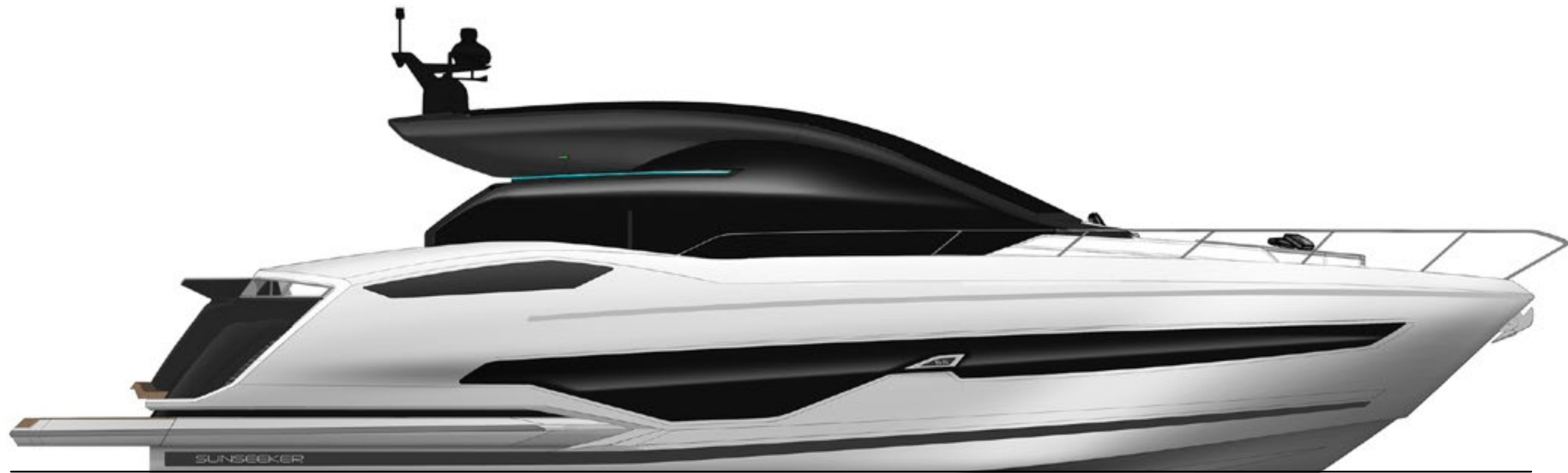

PROFILE

PREDATOR 55
GENERAL ARRANGEMENTS

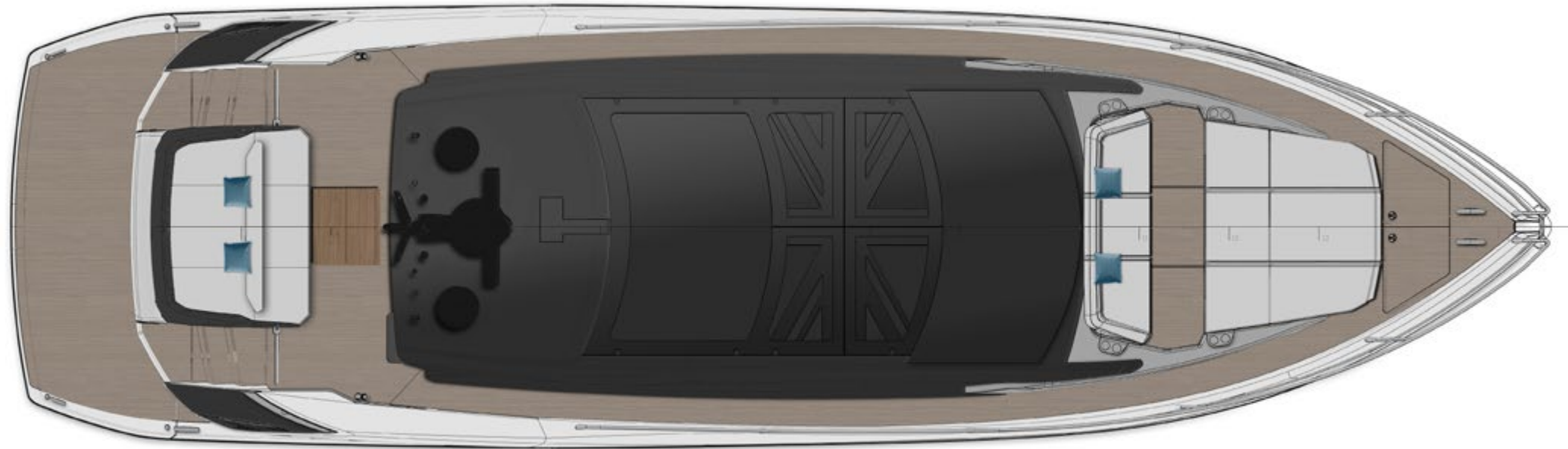

EXTERIOR PLAN

PREDATOR 55

GENERAL ARRANGEMENTS

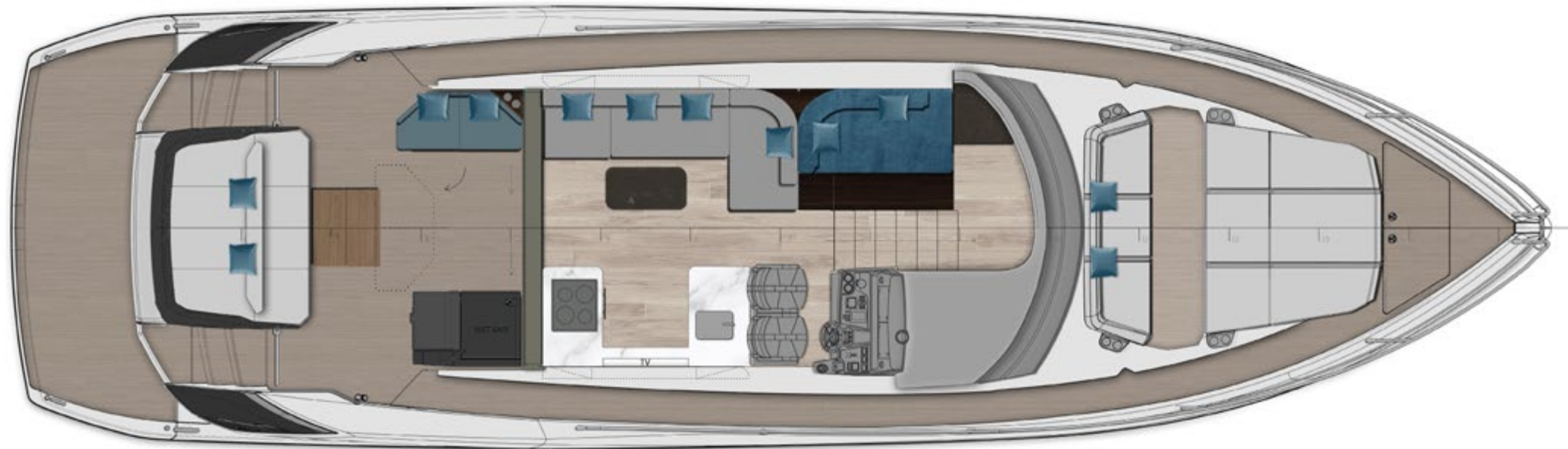

MAIN DECK

PREDATOR 55 GENERAL ARRANGEMENTS



2 CABIN LAYOUT WITH
OPTIONAL UTILITY
ROOM / DAY HEAD

LOWER DECK
2 CABIN LAYOUT

PREDATOR 55 GENERAL ARRANGEMENTS

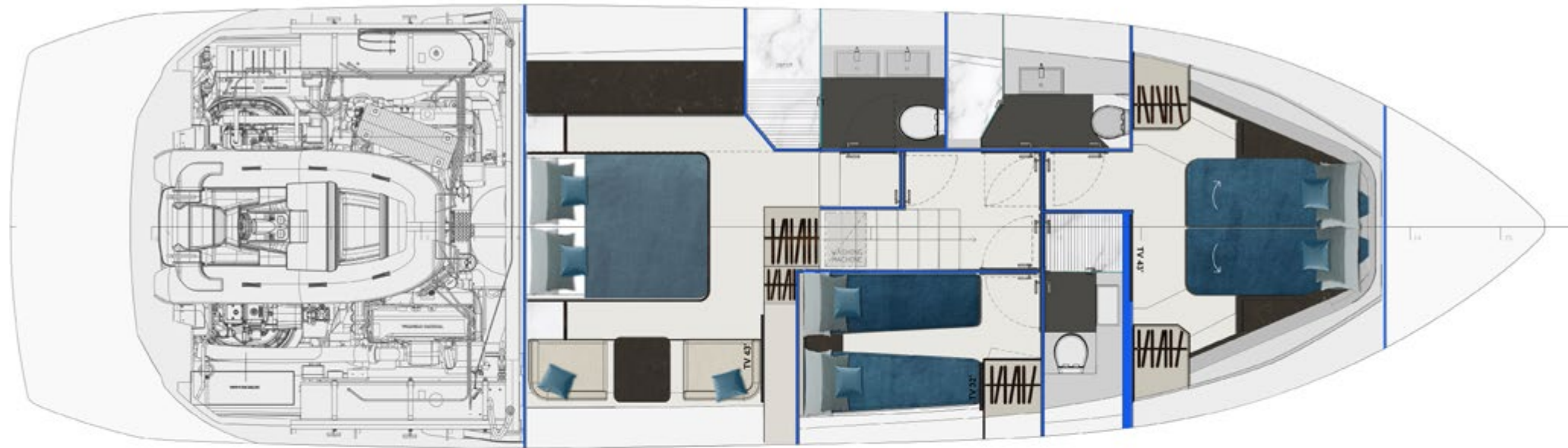

LOWER DECK
OPTIONAL 3 CABIN LAYOUT



PREDATOR 65



PREDATOR 65

Perfectly balancing traditional Sunseeker design concepts with cutting-edge innovation gives us the all-new Predator 65, a dynamic performance model with a purity of line that delivers an exhilarating driving experience with luxurious entertainment spaces to match.





PRINCIPAL CHARACTERISTICS

LENGTH OVERALL
20.50M / 67' 2"

BEAM
5.10M / 16' 8"

DRAFT
1.60 M / 5' 3"

DISPLACEMENT
37,810 KG / 83,357 LB

FUEL CAPACITY
3,500 LITRES / 924 US GAL.

FRESH WATER CAPACITY
800 LITRES / 211 US GAL.

BLACK WATER CAPACITY
200 LITRES / 52 US GAL.

ACCOMMODATION
UP TO 7 GUESTS & UP TO 1 CREW

ENGINE OPTIONS
VOLVO PENTA IPS UP TO 2,000 PS

MAXIMUM SPEED
UP TO 35 KNOTS

RANGE @ 10 KNOTS
UP TO 750 NAUTICAL MILES

DRIVES
PODS













PREDATOR 65
GENERAL ARRANGEMENTS

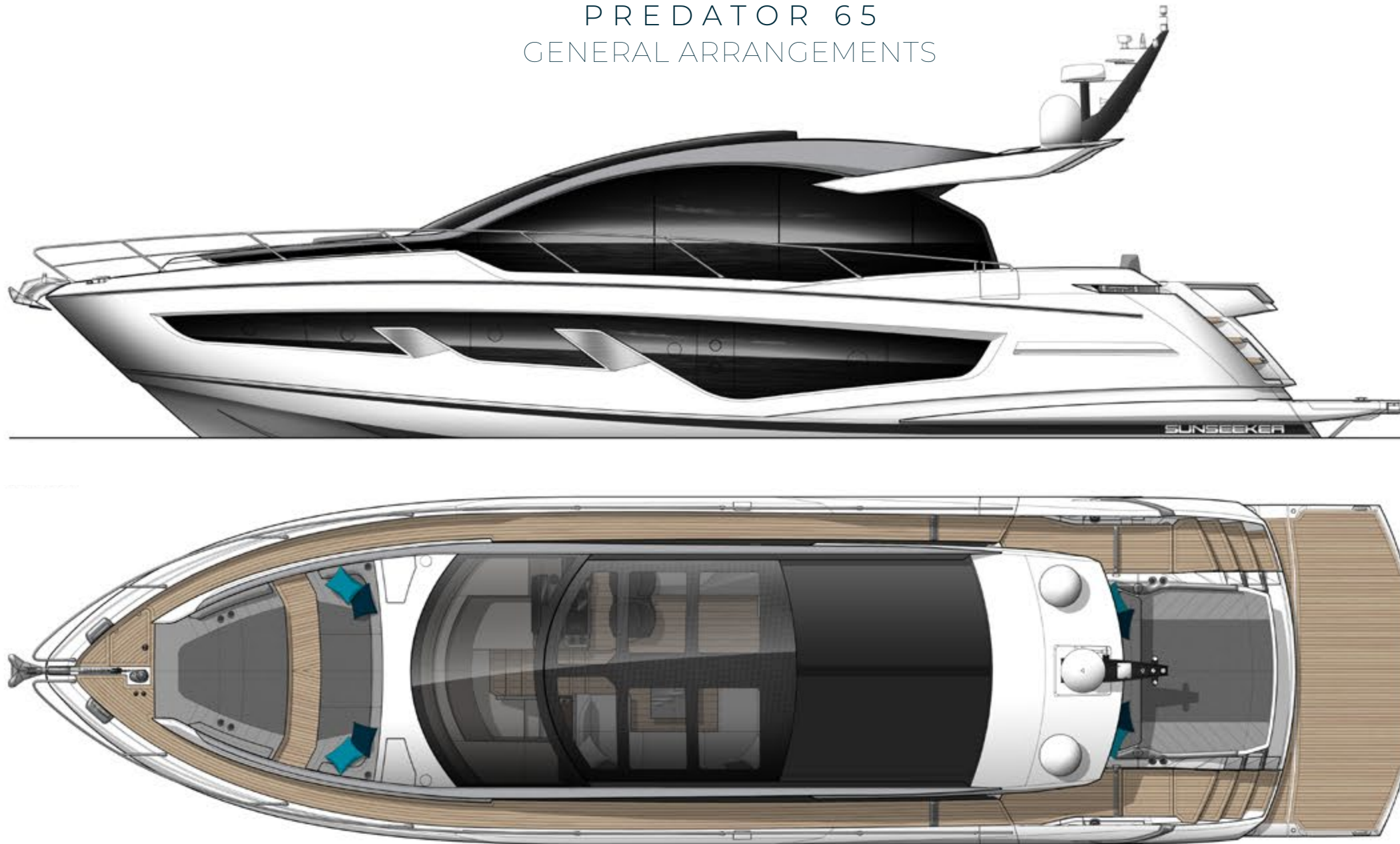

PROFILE AND EXTERIOR PLAN

PREDATOR 65

GENERAL ARRANGEMENTS

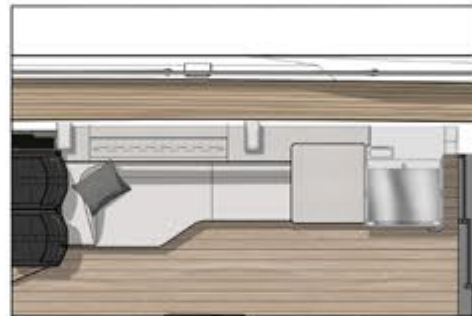

STARBOARD SIDE SOFA WITH RISE
& FALL TV OUTBOARD.



EXTENDED PORT SIDE SEATING TO SUIT LOWER
DECK GALLEY ARRANGEMENT.

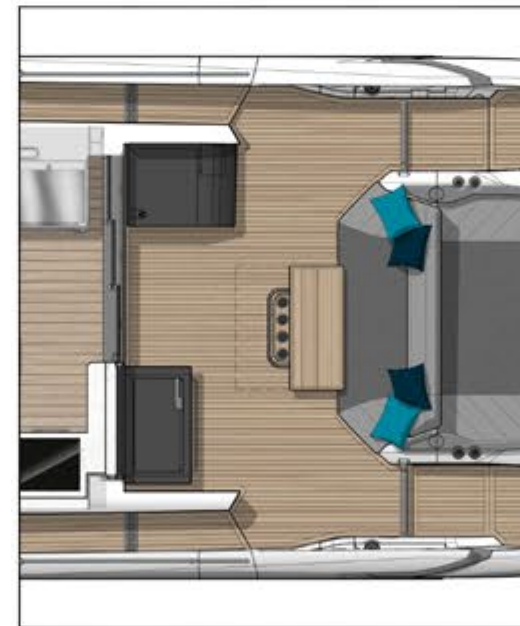

PORT SIDE COCKPIT WETBAR.

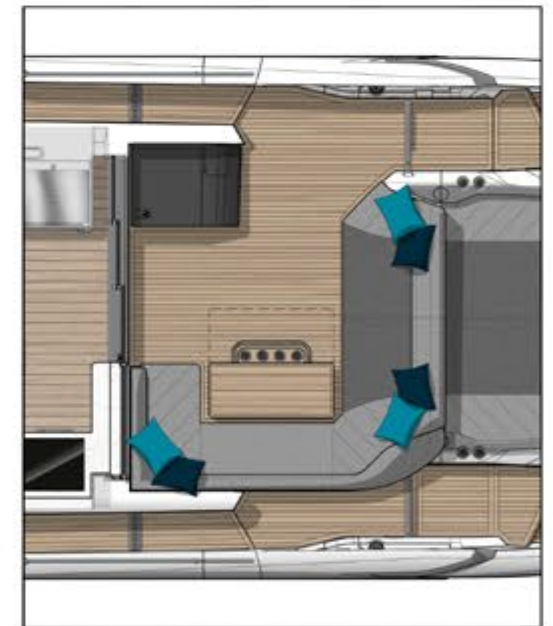

EXTENDED COCKPIT SEATING ARRANGEMENT.

MAIN DECK AND OPTIONS

PREDATOR 65

GENERAL ARRANGEMENTS



EXTENDED MASTER STATEROOM WITH OFFICE AREA



LOWER DECK SALOON



LOWER DECK GALLEY



PORT SIDE SINGLE GUEST CABIN

LOWER DECK AND OPTIONS



PREDATOR 75



PREDATOR 75

Symmetry and space define the Predator 75. Cohesive indoor and outdoor spaces combined with rich interior details and that ever-recognisable sporty silhouette.





PRINCIPAL CHARACTERISTICS

LENGTH OVERALL
23.06 M / 75' 8"

BEAM
5.38 M / 17' 8"

DRAFT (INC. STERN GEAR)
FULL LOAD
1.87 M / 6' 2"

DISPLACEMENT
46,900 KG / 103,396 IB

FUEL CAPACITY
4,800 LITRES / 1,268 US GAL.

FRESHWATER CAPACITY
800 LITRES / 211 US GAL.

BLACK WATER CAPACITY
200 LITRES / 53 US GAL.

ACCOMMODATION
UP TO 8 GUESTS & UP TO 2 CREW

ENGINE OPTIONS
MAN UP TO 3800PS (TOTAL)

MAXIMUM SPEED
UP TO 40 KNOTS

RANGE @ 21 KNOTS
UP TO 330 NAUTICAL MILES

DRIVES
SHAFTS











PREDATOR 75

GENERAL ARRANGEMENTS

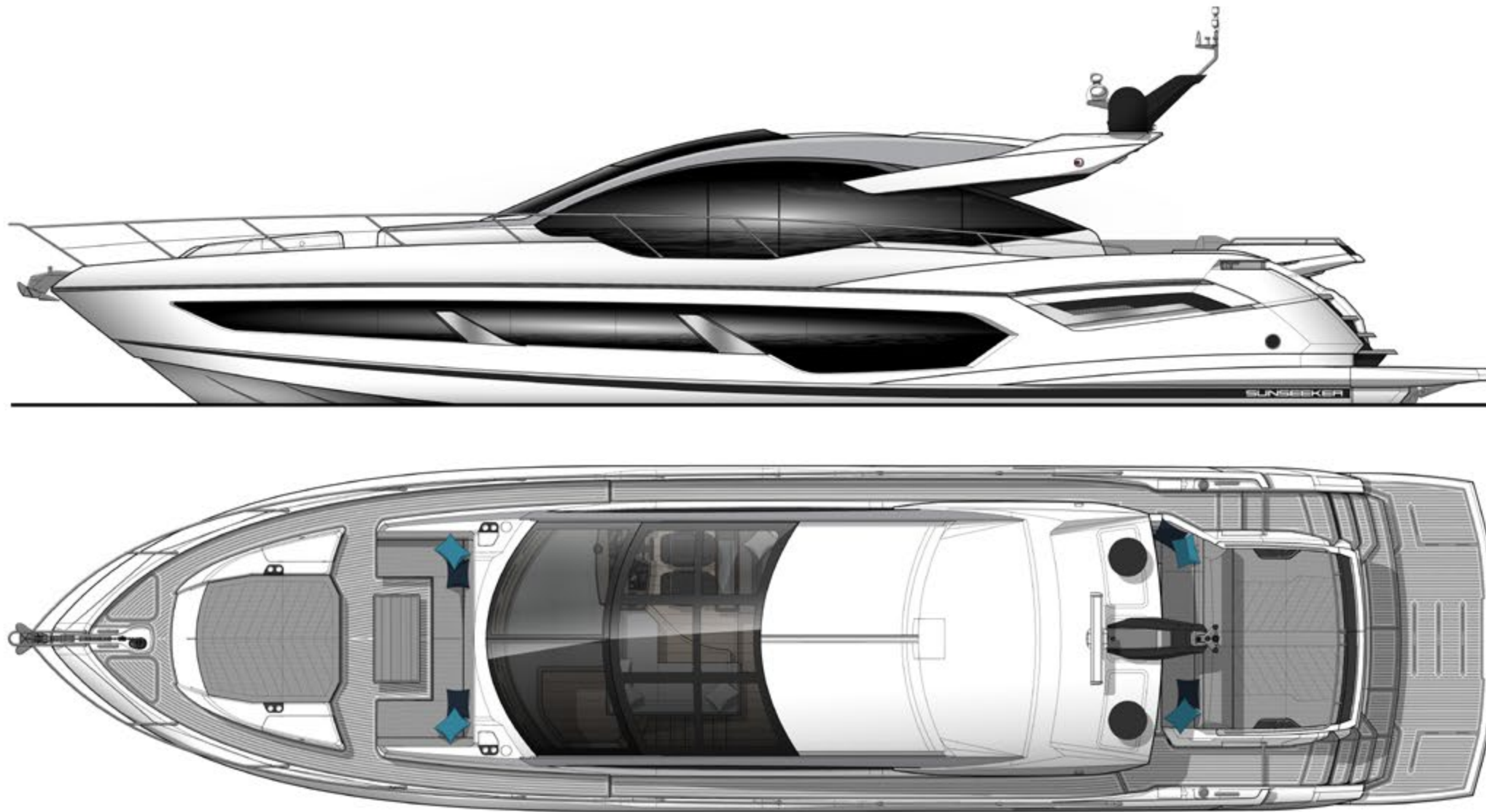

PROFILE AND EXTERIOR PLAN

PREDATOR 75 GENERAL ARRANGEMENTS

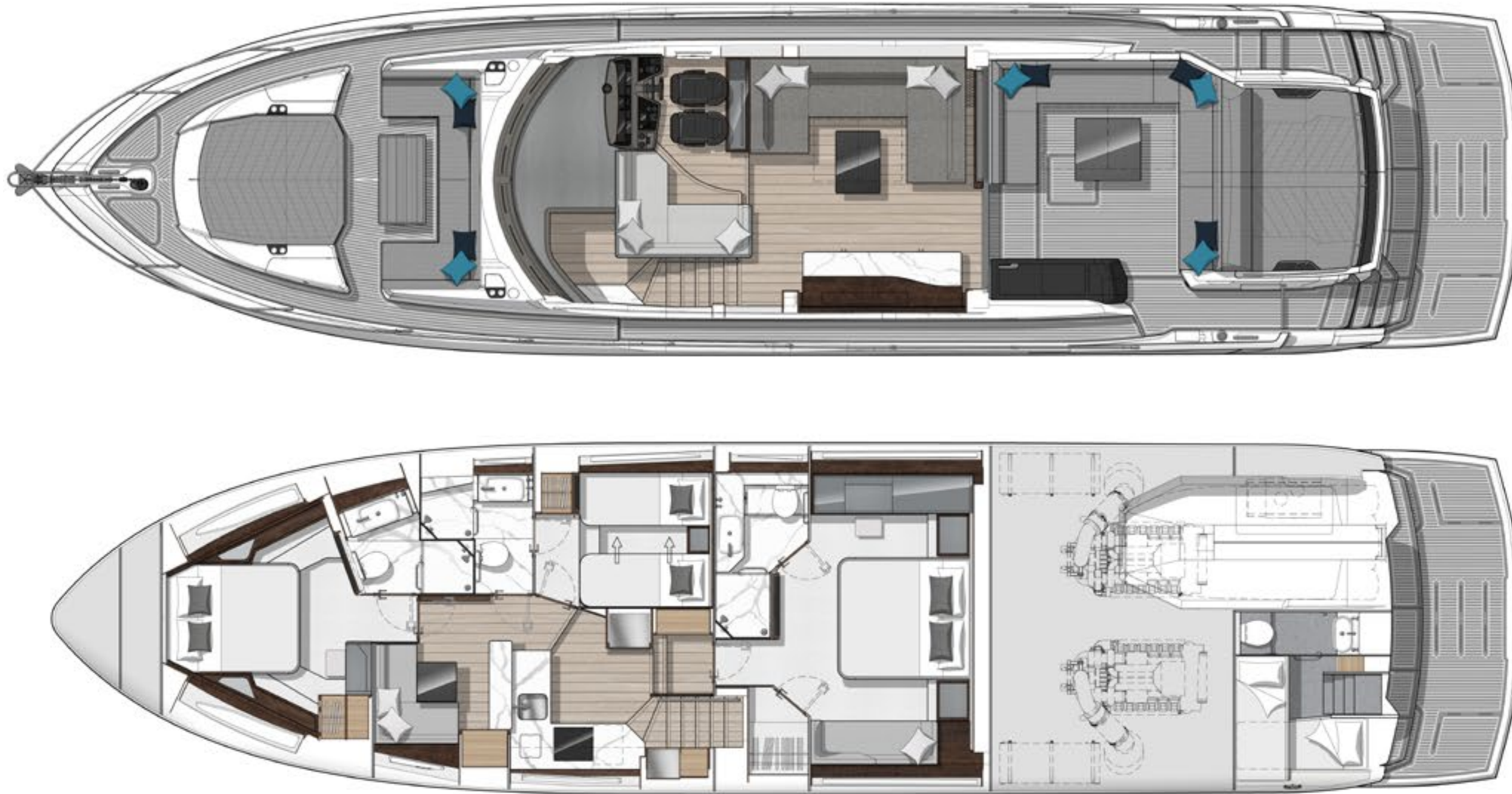

MAIN AND LOWER DECK



SPORT YACHT



55 SPORT YACHT



55 SPORT YACHT

The Sport Yacht concept now in a 55-foot package. The 55 Sport Yacht is an agile performer. Blink, and you might miss it.





PRINCIPAL CHARACTERISTICS

LENGTH OVERALL
17.13M / 56' 2"

BEAM
4.93M / 16' 2"

DRAFT
1.43 M / 4' 8"

FUEL CAPACITY
1,800 LITRES / 476 US GAL.

FRESH WATER CAPACITY
430 LITRES / 114 US GAL.

BLACK WATER CAPACITY
150 LITRES / 39 US GAL.

ACCOMMODATION
UP TO 6 GUESTS

ENGINE OPTIONS
VOLVO PENTA IPS UP TO 1,450 PS

MAXIMUM SPEED
UP TO 38 KNOTS

DRIVES
PODS



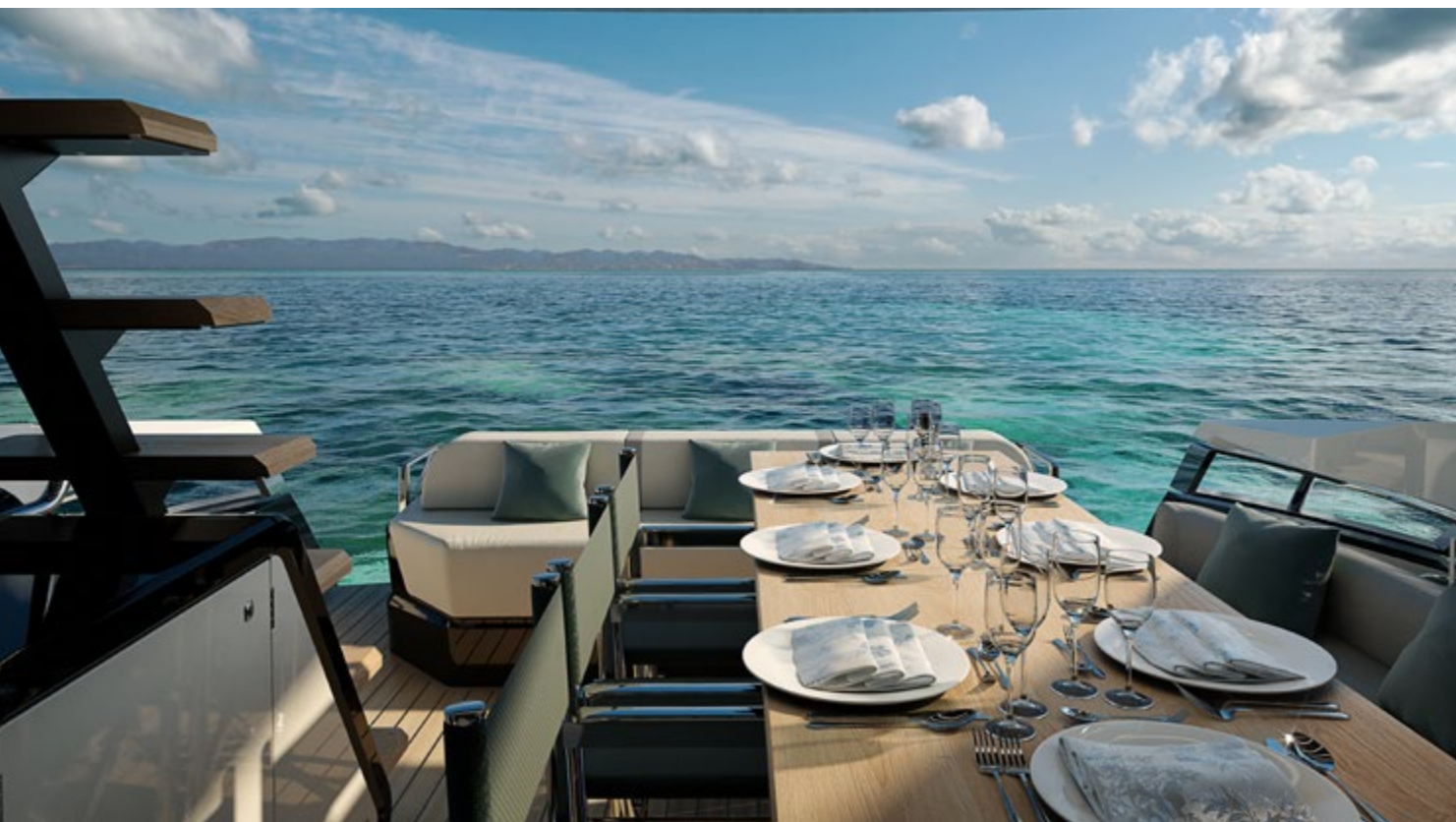





55 SPORT YACHT GENERAL ARRANGEMENTS

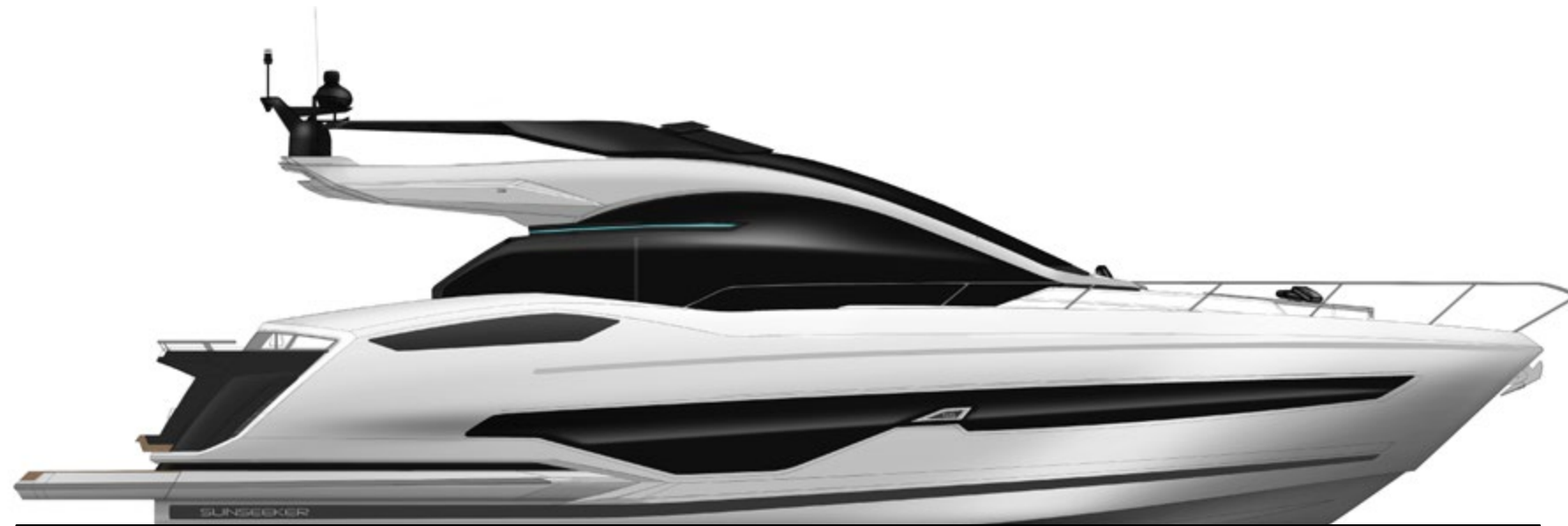

PROFILE

55 SPORT YACHT GENERAL ARRANGEMENTS



EXTERIOR PLAN AND MAIN DECK

55 SPORT YACHT GENERAL ARRANGEMENTS

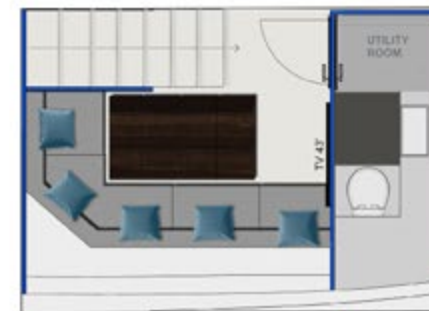

2 CABIN LAYOUT WITH
OPTIONAL UTILITY
ROOM / DAY HEAD

LOWER DECK
2 CABIN LAYOUT

55 SPORT YACHT GENERAL ARRANGEMENTS

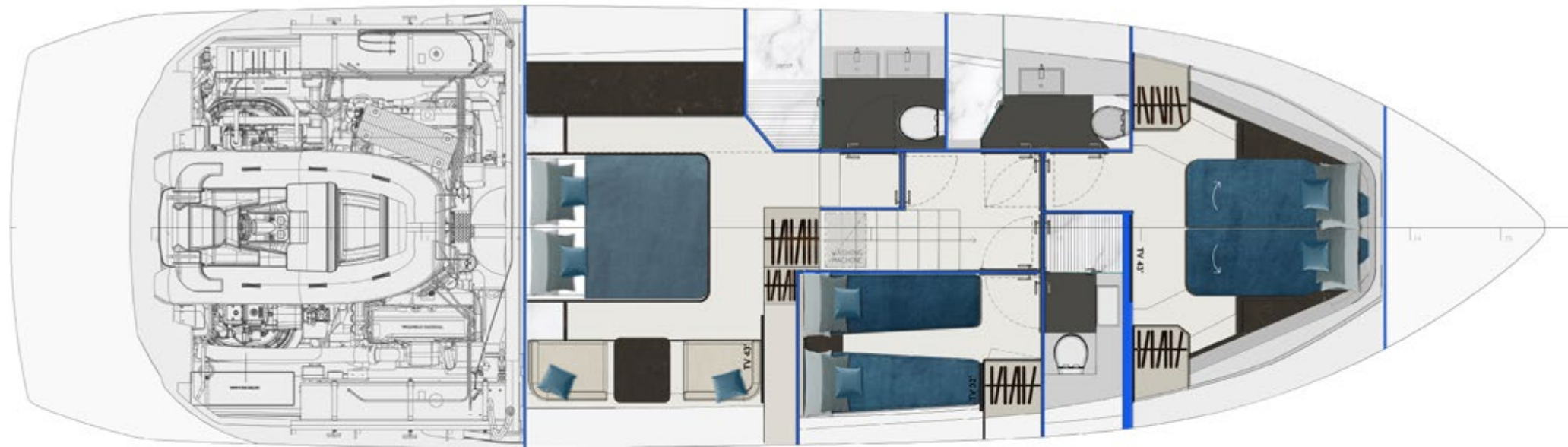

LOWER DECK
OPTIONAL 3 CABIN LAYOUT



65 SPORT YACHT



65 SPORT YACHT

The multi-award-winning 65 Sport Yacht is graceful yet modern. With a pulse-quickening 35 knot top speed, helm seating that's pure supercar, generous interior spaces, and best-in-class garage storage, an unforgettable adventure awaits.





PRINCIPAL CHARACTERISTICS

LENGTH OVERALL
20.50M / 67' 2"

BEAM
5.10M / 16' 8"

DRAFT
1.60 M / 5' 3"

DISPLACEMENT
37,810 KG / 83,357 LB

FUEL CAPACITY
3,500 LITRES / 924 US GAL.

FRESH WATER CAPACITY
800 LITRES / 211 US GAL.

BLACK WATER CAPACITY
200 LITRES / 52 US GAL.

ACCOMMODATION
UP TO 7 GUESTS & UP TO 1 CREW

ENGINE OPTIONS
VOLVO PENTA IPS UP TO 2,000 PS

MAXIMUM SPEED
UP TO 35 KNOTS

RANGE @ 10 KNOTS
UP TO 750 NAUTICAL MILES

DRIVES
PODS















65 SPORT YACHT GENERAL ARRANGEMENTS

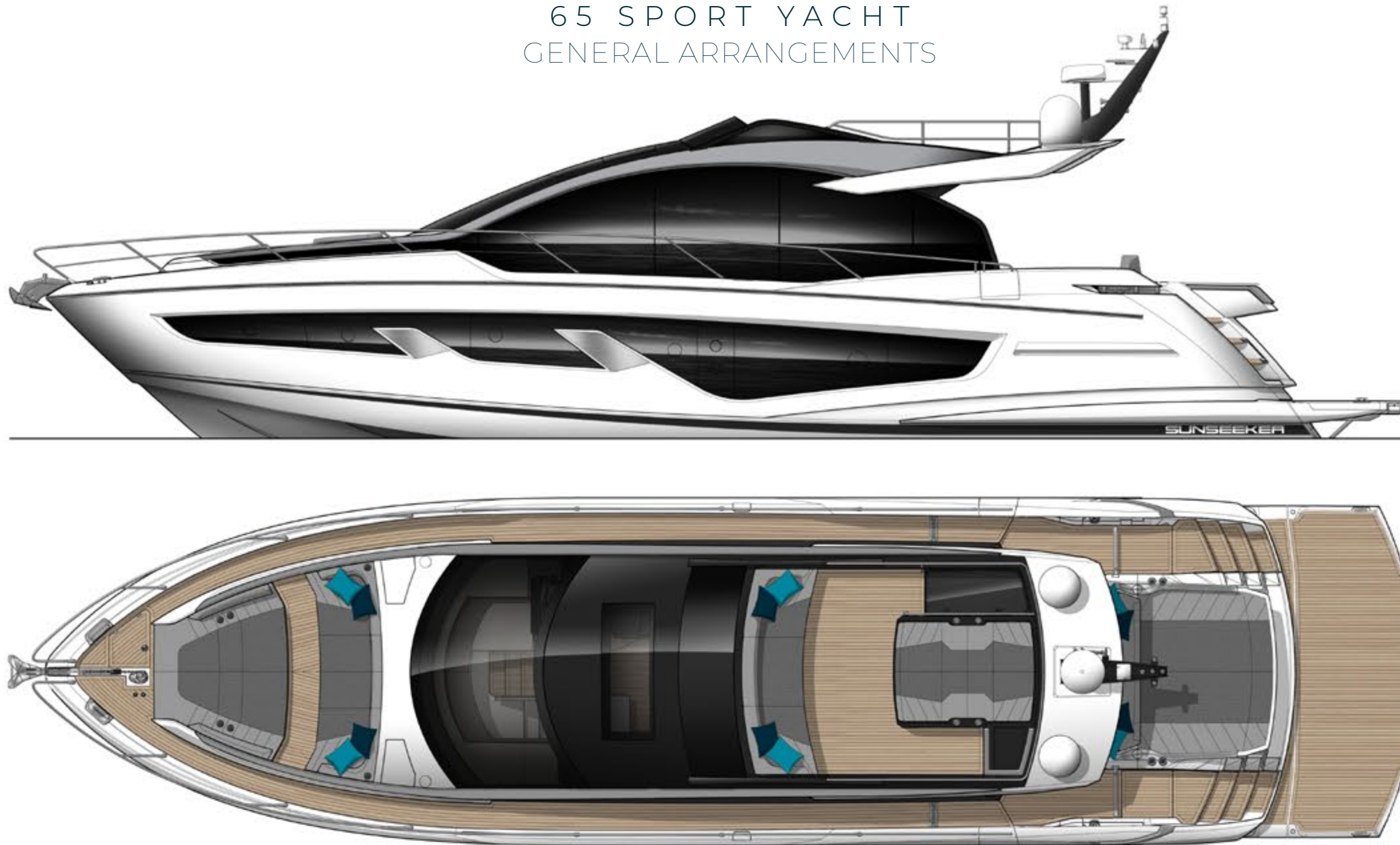

PROFILE AND FLYBRIDGE

65 SPORT YACHT GENERAL ARRANGEMENTS

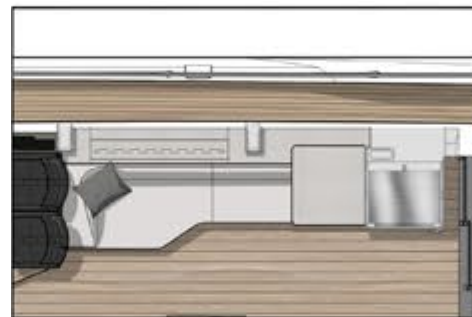

STARBOARD SIDE SOFA WITH RISE
& FALL TV OUTBOARD.

MAIN DECK AND OPTIONS



EXTENDED PORT SIDE SEATING TO SUIT LOWER
DECK GALLEY ARRANGEMENT.

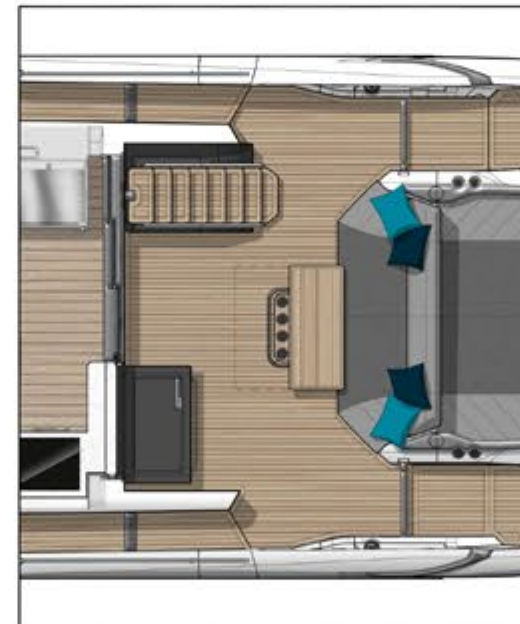

PORT SIDE COCKPIT WETBAR.

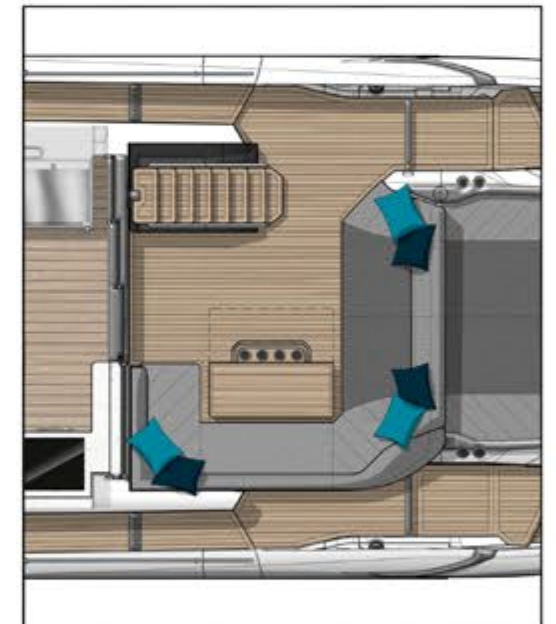

EXTENDED COCKPIT SEATING ARRANGEMENT.

65 SPORT YACHT GENERAL ARRANGEMENTS



EXTENDED MASTER STATEROOM WITH OFFICE AREA



LOWER DECK SALOON



LOWER DECK GALLEY



PORT SIDE SINGLE GUEST CABIN

LOWER DECK AND OPTIONS



75 SPORT YACHT



75 SPORT YACHT

The ultimate driving position awaits on the 75 Sport Yacht. Feel close to the elements on the flybridge or retreat into comfort below decks.





PRINCIPAL CHARACTERISTICS

LENGTH OVERALL
23.06M / 75' 8"

BEAM
5.38M / 17' 8"

DRAFT
1.87 M / 6' 2"

DISPLACEMENT
46,900 KG / 103,396 LB

FUEL CAPACITY
4,800 LITRES / 1,268 US GAL.

FRESH WATER CAPACITY
800 LITRES / 211 US GAL.

BLACK WATER CAPACITY
200 LITRES / 53 US GAL.

ACCOMMODATION
UP TO 8 GUESTS & UP TO 2 CREW

ENGINE OPTIONS
MAN UP TO 3,800 PS

MAXIMUM SPEED
UP TO 40 KNOTS

RANGE @ 10 KNOTS
UP TO 900 NAUTICAL MILES

DRIVES
SHAFTS









75 SPORT YACHT GENERAL ARRANGEMENTS

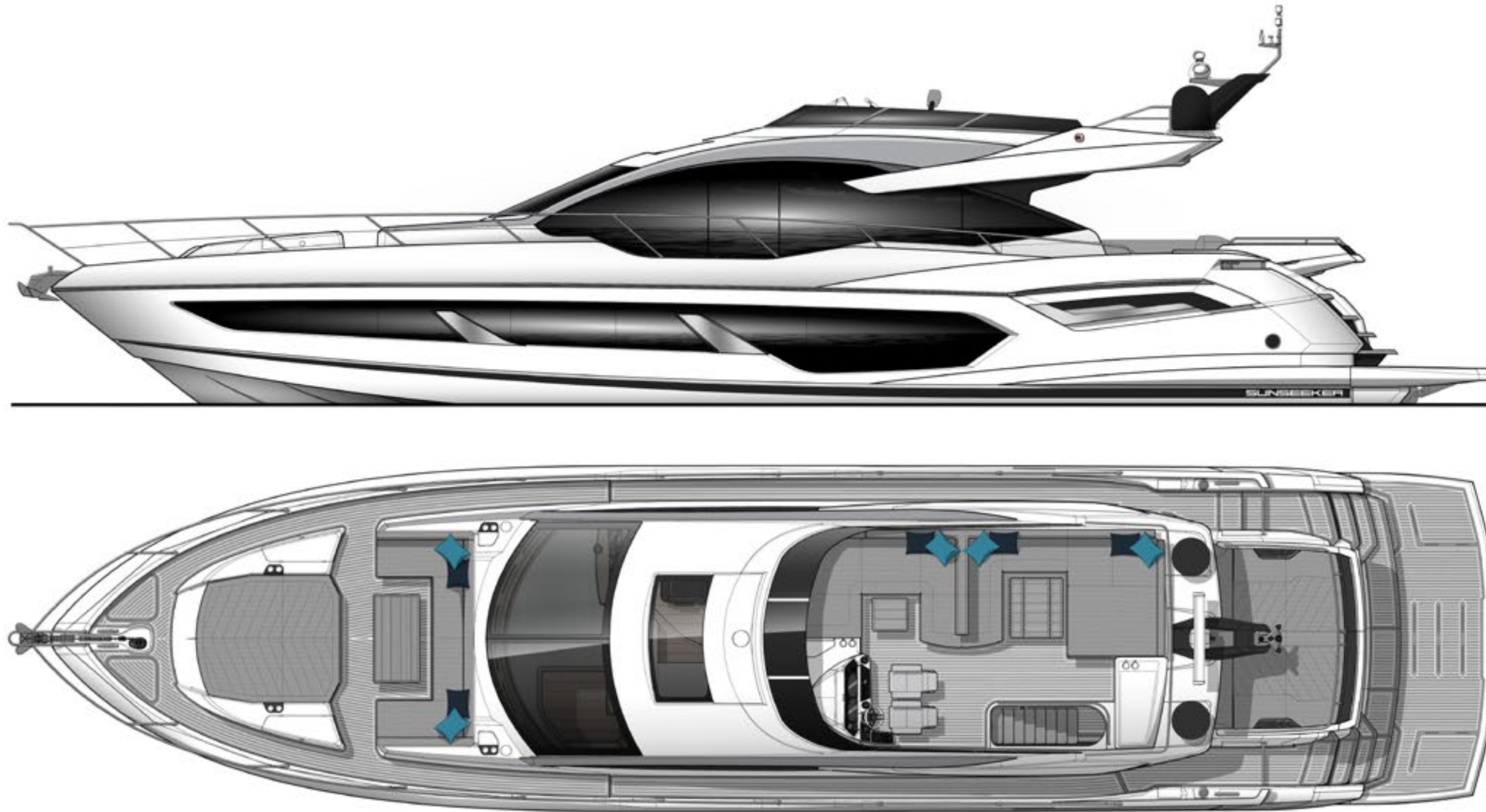

PROFILE AND FLYBRIDGE

75 SPORT YACHT GENERAL ARRANGEMENTS

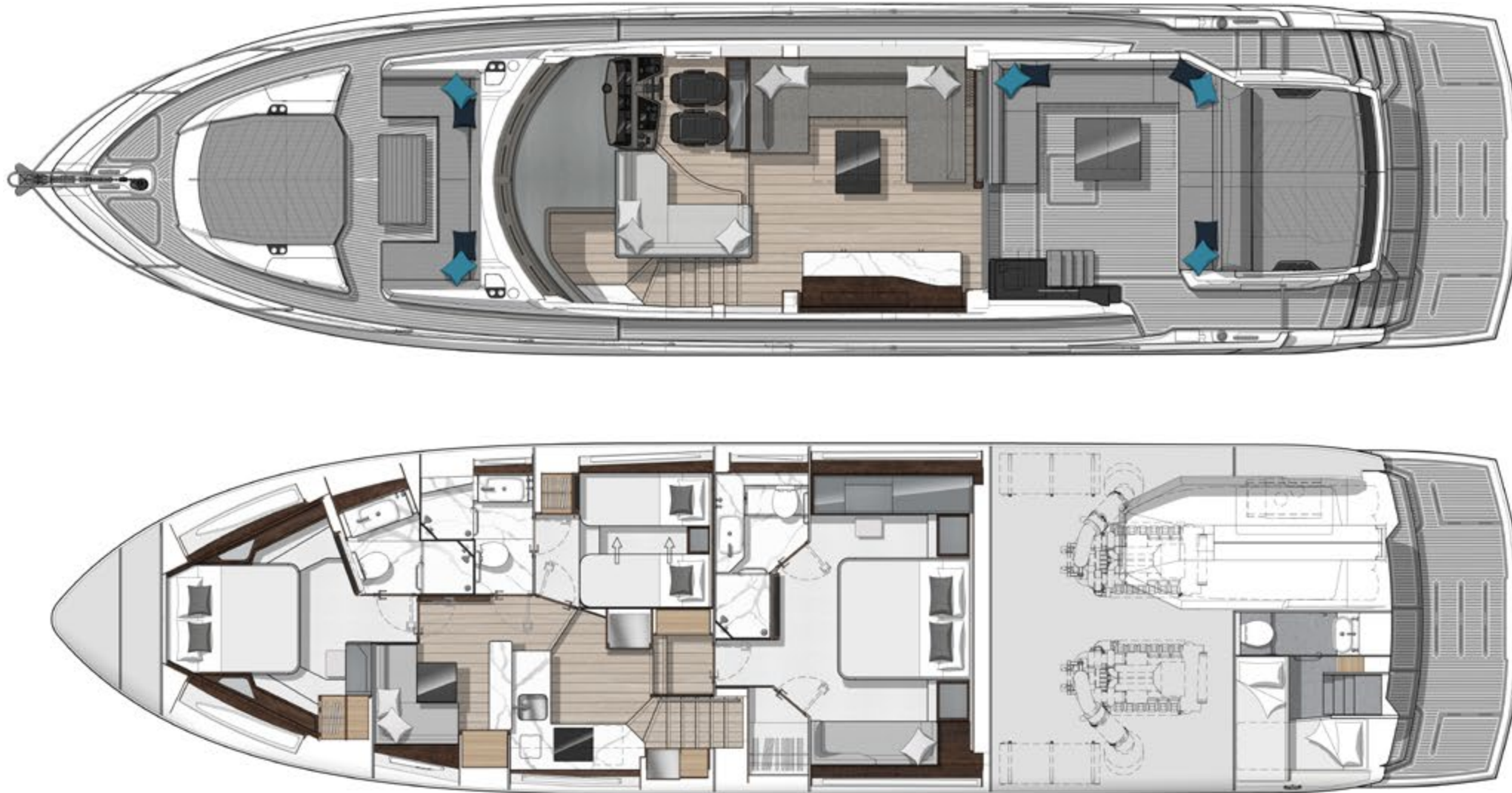

MAIN AND LOWER DECK

An aerial photograph showing a vast expanse of turquoise water with visible ripples and a sandy beach at the bottom. The word "MANHATTAN" is centered in the water.

MANHATTAN



MANHATTAN 55



MANHATTAN 55

Beauty and comfort take their rightful place cruising out at sea, courtesy of the luxurious Manhattan 55. Perfectly proportioned and elegantly designed, its deceptively generous spaces provide endless opportunities to entertain and socialise. With a range of 250 nautical miles and capable of 32 knots at full throttle, this beauty has performance to match.





PRINCIPAL CHARACTERISTICS

LENGTH OVERALL
17.21M / 56' 6"

BEAM
4.87M / 16' 0"

DRAFT
1.37M / 4' 6"

DISPLACEMENT
27,000 KG / 59,524 LB

FUEL CAPACITY
2,200 LITRES / 580 US GAL.

FRESH WATER CAPACITY
600 LITRES / 158 US GAL.

BLACK WATER CAPACITY
150 LITRES / 39 US GAL.

ACCOMMODATION
UP TO 6 GUESTS & UP TO 1 CREW

ENGINE OPTIONS
VOLVO PENTA UP TO 1,600 PS
(TOTAL)

MAXIMUM SPEED
UP TO 32 KNOTS

RANGE @ 21 KNOTS
UP TO 230 NAUTICAL MILES

DRIVES
SHAFTS OR PODS















MANHATTAN 55 GENERAL ARRANGEMENTS



PROFILE AND FLYBRIDGE

MANHATTAN 55 GENERAL ARRANGEMENTS



MAIN AND LOWER DECK



MANHATTAN 68



MANHATTAN 68

The Manhattan 68 has one sole purpose. Effortless entertainment. With generous and flexible social spaces, large sunbathing areas, a well-equipped wet bar and a revolutionary aft Beach Club area, the Manhattan 68 is every inch the socialite. Comfort and luxury extend to all four cabins with flexibility across numerous layouts key to this yacht's success.





PRINCIPAL CHARACTERISTICS

LENGTH OVERALL
21.21M / 69' 7"

BEAM
5.26M / 17' 3"

DRAFT
1.60 M / 5' 4"

DISPLACEMENT
37,400 KG / 82,453 LB

FUEL CAPACITY
4,000 LITRES / 1,057 US GAL.

FRESH WATER CAPACITY
900 LITRES / 238 US GAL.

BLACK WATER CAPACITY
200 LITRES / 53 US GAL.

ACCOMMODATION
UP TO 8 GUESTS & UP TO 2 CREW

ENGINE OPTIONS
MAN OR VOLVO PENTA IPS UP TO
2,400 PS

MAXIMUM SPEED
UP TO 32 KNOTS

RANGE @ 10 KNOTS
UP TO 550 NAUTICAL MILES

DRIVES
SHAFTS OR PODS







MANHATTAN 68 STANDARD LAYOUT



MANHATTAN 68 PACIFIC LAYOUT





MANHATTAN 68 PACIFIC OPTION



MANHATTAN 68

GENERAL ARRANGEMENTS



PROFILE AND FLYBRIDGE

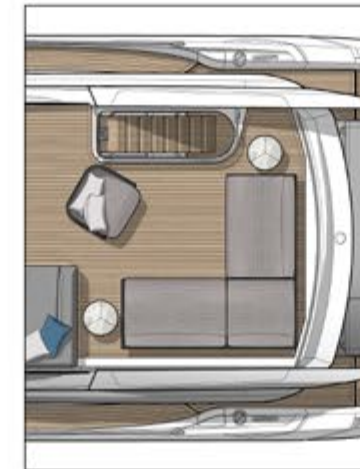

OPTIONAL FLYBRIDGE
ARRANGEMENT WITH
LOOSE FURNITURE

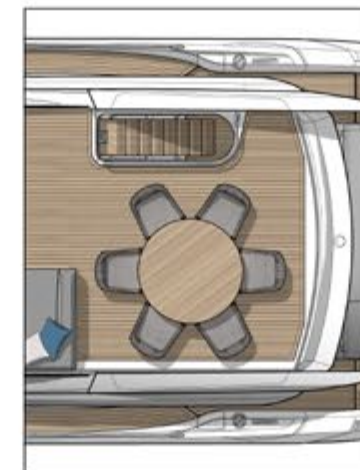

OPTIONAL FLYBRIDGE
ARRANGEMENT
WITH DINING TABLE
AND 6 CHAIRS



OPTIONAL FLYBRIDGE
ARRANGEMENT WITH
FIXED GRP SEATING
AND TABLE

MANHATTAN 68 GENERAL ARRANGEMENTS

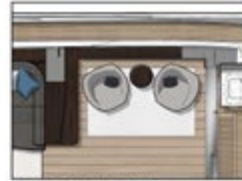

OPTIONAL FEATURE BAR /
SNUG IN LIEU
OF GALLEY



OPTIONAL LOWER
DECK GALLEY

MAIN AND LOWER DECK
MANHATTAN 68

MAIN AND LOWER DECK
MANHATTAN 68 PACIFIC

A full-page photograph of a sunset over the ocean. The sun is a bright, glowing orb in the upper center, casting a warm orange and yellow light across the sky. The horizon is visible in the middle ground, with the sun's reflection shimmering on the water's surface. The foreground shows the dark, textured crests of ocean waves, with some highlights from the setting sun. The word "YACHT" is centered in the sky, written in a clean, white, sans-serif font.

YACHT



76 YACHT



76 YACHT

The award-winning 76 Yacht has it all with a host of luxurious entertainment areas complemented by peerless design features. Enjoy panoramic views from the stunning main deck or drive from the flybridge for an unmatched yachting experience.





PRINCIPAL CHARACTERISTICS

LENGTH OVERALL
23.60M / 77' 5"

BEAM
5.95M / 19' 6"

DRAFT
1.70M / 5' 7"

DISPLACEMENT
53,700 KG / 118,140 LB

FUEL CAPACITY
6,000 LITRES / 1,585 US GAL.

FRESH WATER CAPACITY
1,400 LITRES / 370 US GAL.

BLACK WATER CAPACITY
400 LITRES / 106 US GAL.

ACCOMMODATION
UP TO 8 GUESTS & UP TO 3 CREW

ENGINE OPTIONS
MAN UP TO 3,100 PS (TOTAL)

MAXIMUM SPEED
UP TO 32 KNOTS

RANGE @ 10 KNOTS
UP TO 500 NAUTICAL MILES

DRIVES
SHAFTS









76 YACHT AFT GALLEY LAYOUT



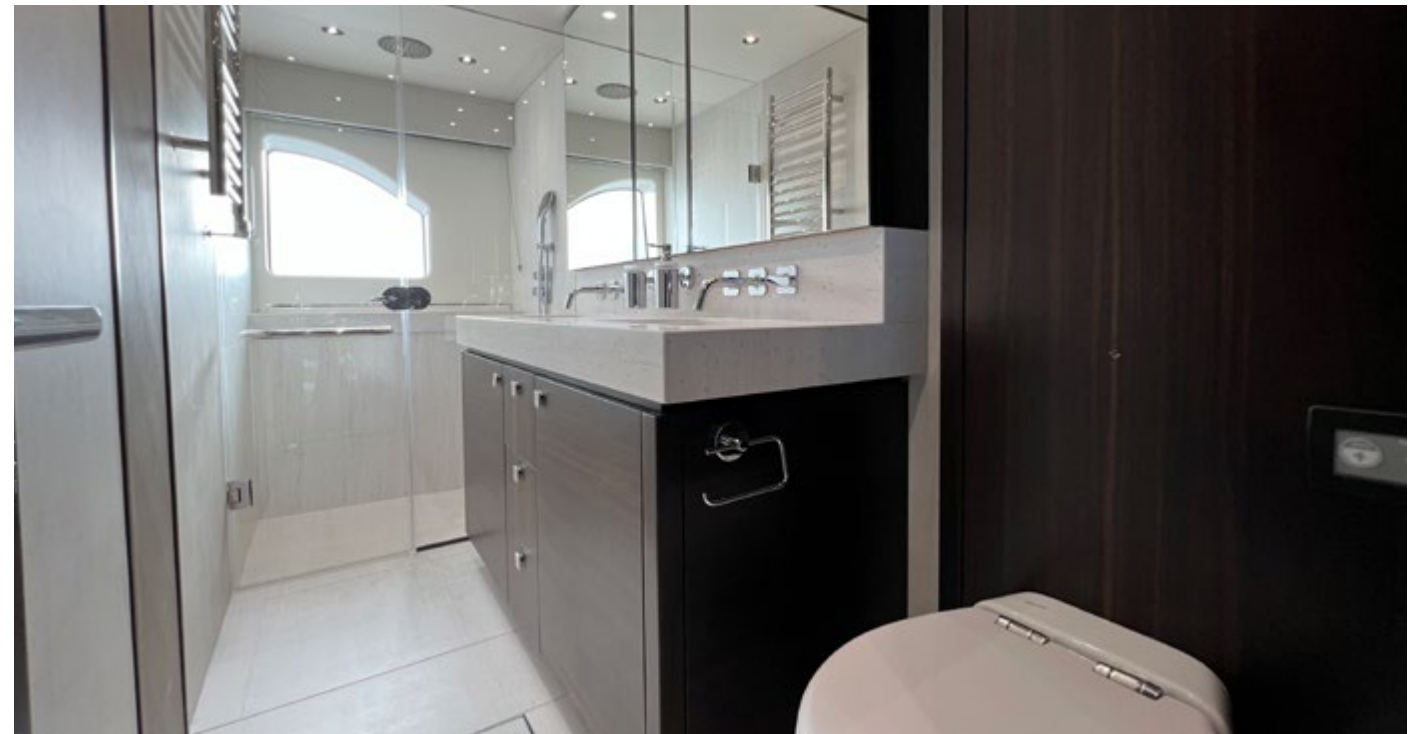

76 YACHT GENERAL ARRANGEMENTS



PROFILE AND FLYBRIDGE

76 YACHT
GENERAL ARRANGEMENTS



STANDARD LAYOUT



AFT GALLEY LAYOUT

MAIN DECK

76 YACHT GENERAL ARRANGEMENTS



LOWER DECK



88 YACHT



88 YACHT

The award-winning 88 Yacht. A powerful combination of seductive styling with smart practical spaces, incorporating a built-in hardtop, cleverly configured interior and a sumptuous master cabin layout. The Beach Club, complete with an innovative Sunseeker X-TEND™ sunbed to the aft, makes this an icon worthy of your immediate attention.





PRINCIPAL CHARACTERISTICS

LENGTH OVERALL
26.38 M / 86' 7"

BEAM
6.47M / 21' 3"

DRAFT
2.12M / 7' 0"

DISPLACEMENT
77,300 KG / 170,417 LB

FUEL CAPACITY
11,000 LITRES / 2,907 US GAL.

FRESH WATER CAPACITY
1,400 LITRES / 370 US GAL.

BLACK WATER CAPACITY
400 LITRES / 106 US GAL.

ACCOMMODATION
UP TO 8 GUESTS & UP TO 4 CREW

ENGINE OPTIONS
MTU UP TO 4,002 PS

MAXIMUM SPEED
UP TO 28 KNOTS

RANGE @ 10/12 KNOTS
UP TO 1,275 NAUTICAL MILES

DRIVES
SHAFTS



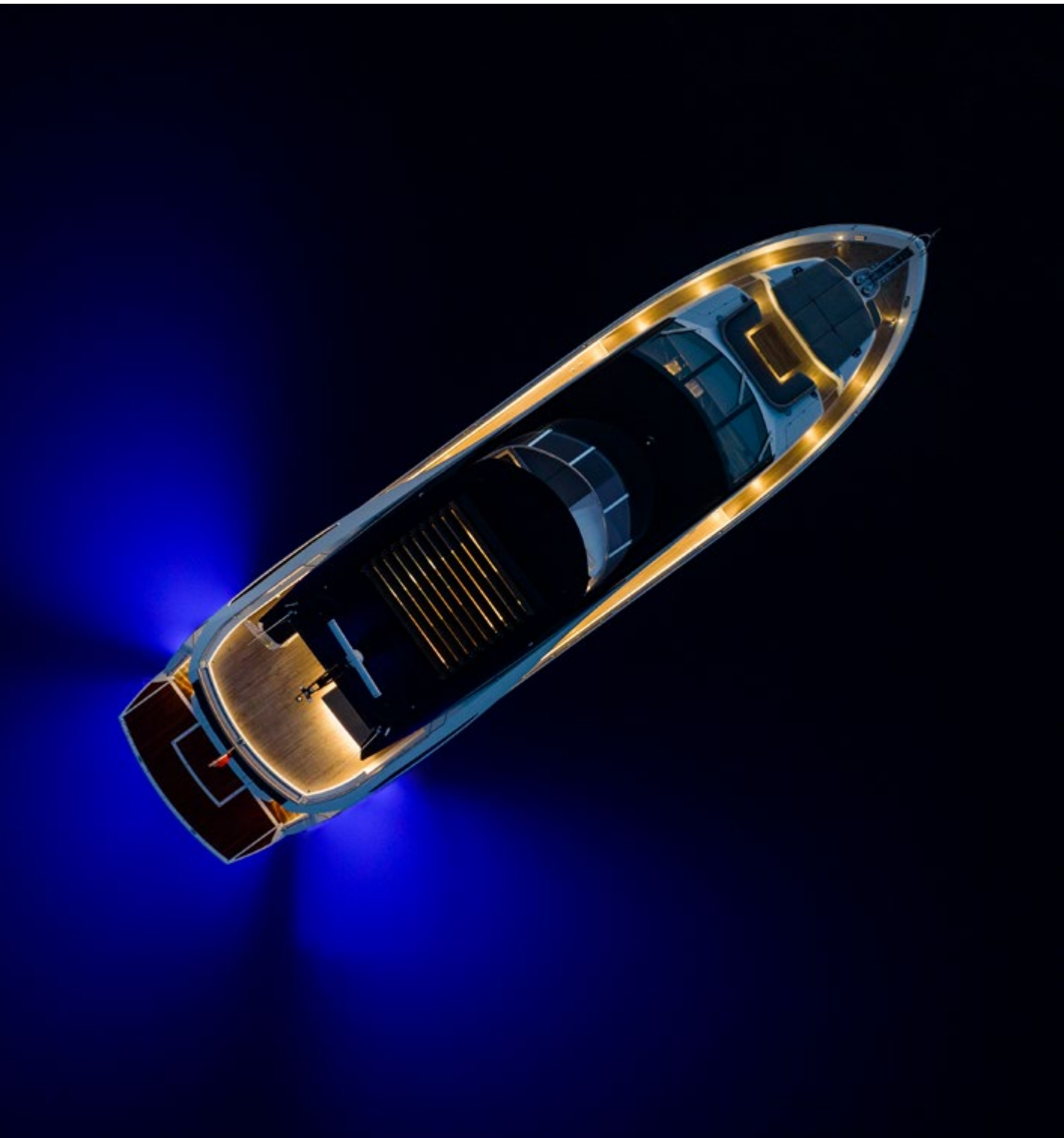









88 YACHT GENERAL ARRANGEMENTS



PROFILE AND FLYBRIDGE

88 YACHT GENERAL ARRANGEMENTS

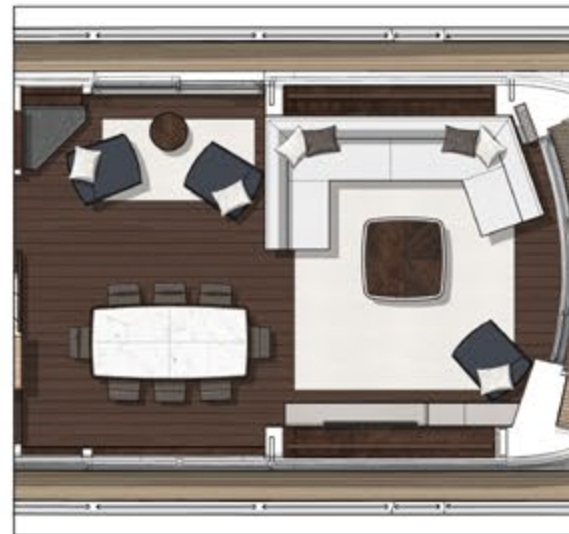

MAIN DECK OPTION
SHOWN WITH ALTERNATIVE SALOON
AND DINING ARRANGEMENT

MAIN DECK AND OPTIONS

88 YACHT
GENERAL ARRANGEMENTS

LOWER DECK OPTION
SHOWN WITH OPTIONAL SOFA
IN MASTER STATEROOM

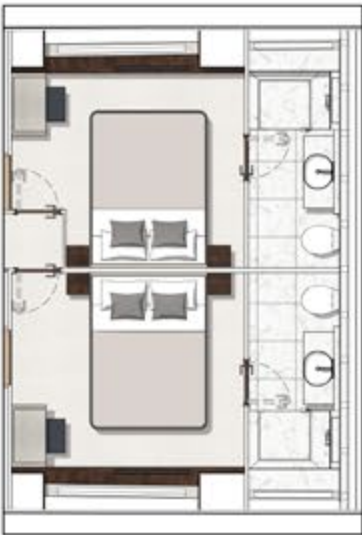

LOWER DECK OPTION
SHOWN WITH AFT DOUBLE GUEST CABINS
IN LIEU OF MASTER STATEROOM



LOWER DECK AND OPTIONS



95 YACHT



95 YACHT

Perfection touches every corner of the 95 Yacht, a floating oasis dedicated to luxury and craftsmanship. A streamlined exterior teases the eye with a tingling sense of style and beauty that flows uninterrupted into the graceful and spacious interior. From the raised pilothouse and dedicated lower guest cabins to the spectacular triplex master cabin, the 95 Yacht is the epitome of refinement.





PRINCIPAL CHARACTERISTICS

LENGTH OVERALL
28.06M / 92' 1"

BEAM
6.55M / 21' 6"

DRAFT
2.13 M / 7' 0"

DISPLACEMENT
84,700 KG / 186,731 LB

FUEL CAPACITY
12,000 LITRES / 3,170 US GAL.

FRESH WATER CAPACITY
1,750 LITRES / 462 US GAL.

BLACK WATER CAPACITY
435 LITRES / 115 US GAL.

GREY WATER CAPACITY
1,000 LITRES / 264 US GAL.

ACCOMMODATION
UP TO 10 GUESTS & UP TO 4
CREW

ENGINE OPTIONS
MTU UP TO 4,002PS

MAXIMUM SPEED
UP TO 26.5 KNOTS

RANGE @ 10/12 KNOTS
UP TO 1,400 NAUTICAL MILES

DRIVES
SHAFTS















95 YACHT GENERAL ARRANGEMENTS



PROFILE AND FLYBRIDGE

95 YACHT GENERAL ARRANGEMENTS



MAIN AND LOWER DECK



100 YACHT



100 YACHT

A true showpiece, the 100 Yacht is a grand statement of refinement and sophistication. Eloquently expressed through its striking lines, full-beam master cabin, seamless transition from flybridge to foredeck, and fully glazed wheelhouse. Here everything is possible and rules are meant to be broken.





PRINCIPAL CHARACTERISTICS

LENGTH OVERALL
29.85M / 97' 11"

BEAM
6.90M / 22' 8"

DRAFT
2.10M / 6' 10"

DISPLACEMENT
99,380 KG / 219,095 LB

FUEL CAPACITY
12,800 LITRES / 3,381 US GAL.

FRESH WATER CAPACITY
1,800 LITRES / 476 US GAL.

BLACK WATER CAPACITY
1,125 LITRES / 297 US GAL.

GREY WATER CAPACITY
1,125 LITRES / 297 US GAL.

ACCOMMODATION
UP TO 10 GUESTS & UP TO 5 CREW

ENGINE OPTIONS
MTU UP TO 5,280 PS

MAXIMUM SPEED
UP TO 30 KNOTS

RANGE @ 10/12 KNOTS
UP TO 1,300 NAUTICAL MILES

DRIVES
SHAFTS















100 YACHT GENERAL ARRANGEMENTS

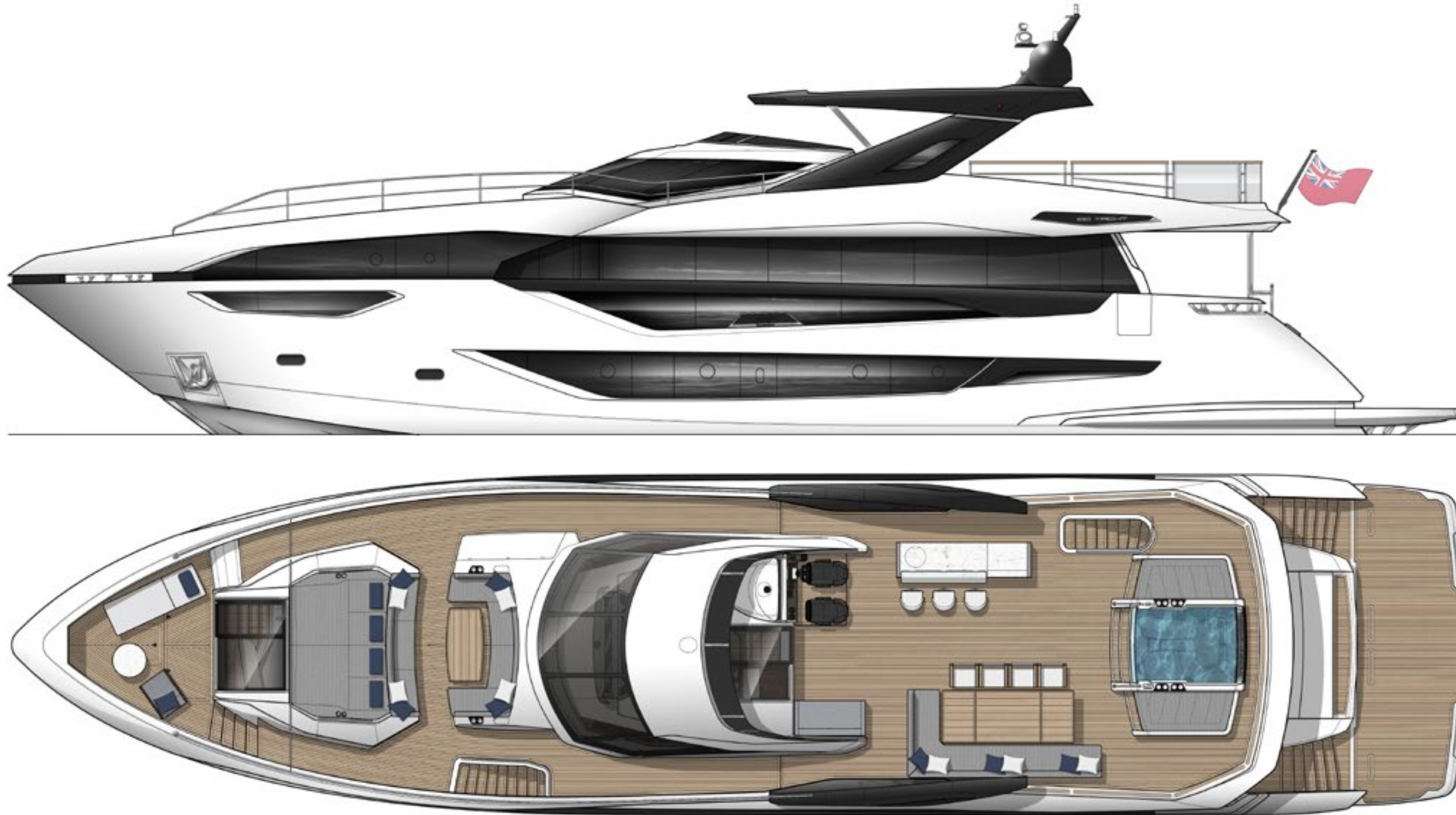

PROFILE AND FLYBRIDGE

100 YACHT GENERAL ARRANGEMENTS



MAIN AND LOWER DECK

OCEAN



OCEAN 156



OCEAN 156

A departure from a typical naming convention, the Ocean 156 is a stunning yacht with exceptional interior volume. Met with ultra-indulgent interior styling, the Ocean 156 is a sanctuary.





PRINCIPAL CHARACTERISTICS

LENGTH OVERALL
25.14M / 82' 6"

BEAM
6.56M / 21' 6"

FUEL CAPACITY
8,500 LITRES / 2,245 US GAL.

FRESH WATER CAPACITY
1,500 LITRES / 396 US GAL.

BLACK WATER CAPACITY
800 LITRES / 211 US GAL.

GREY WATER CAPACITY
1,250 LITRES / 300 US GAL.

ENGINES
MAN UP TO 3,300 PS

RANGE @ 10/12 KNOTS
UP TO 900 NAUTICAL MILES









OCEAN 156

GENERAL ARRANGEMENTS



PROFILE

OCEAN 156 GENERAL ARRANGEMENTS



SHOWN WITH
OPTIONAL
LOOSE SEATING
ARRANGEMENT

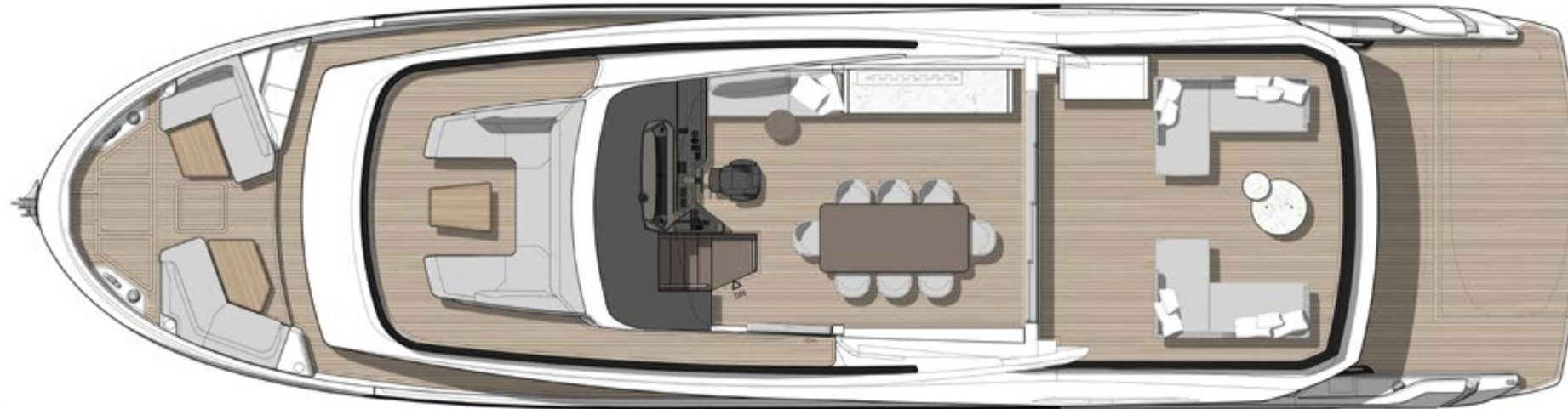

SHOWN WITH
OPTIONAL INTERIOR
DINING ARRANGEMENT
AND UPPER DECK
LOOSE SEATING
ARRANGEMENT

UPPER DECK AND OPTIONS

OCEAN 156

GENERAL ARRANGEMENTS

SHOWN WITH
OPTIONAL
TWIN ANCHOR
ARRANGEMENT,
FORWARD PATIO
DOOR, GALLEY
SIDE DECK DOOR,
DAYHEAD AND
SUNSEEKER X-TEND™
TRANSFORMER
SUNBEAD
ARRANGEMENT



SHOWN WITH
OPTIONAL
TWIN ANCHOR
ARRANGEMENT,
FORWARD PATIO
DOOR, FORWARD
SALOON / AFT DINING
ARRANGEMENT,
GALLEY SIDE DECK
DOOR, DAYHEAD AND
SUNSEEKER X-TEND™
TRANSFORMER
SUNBEAD
ARRANGEMENT



MAIN DECK OPTIONS

OCEAN 156
GENERAL ARRANGEMENTS

SHOWN WITH
OPTIONAL
TWIN ANCHOR
ARRANGEMENT,
FORWARD PATIO
DOOR, FORWARD
DINING / SALOON
ARRANGEMENT,
GALLEY SIDE DECK
DOOR, DAYHEAD AND
SUNSEEKER X-TEND™
TRANSFORMER
SUNBEAD
ARRANGEMENT

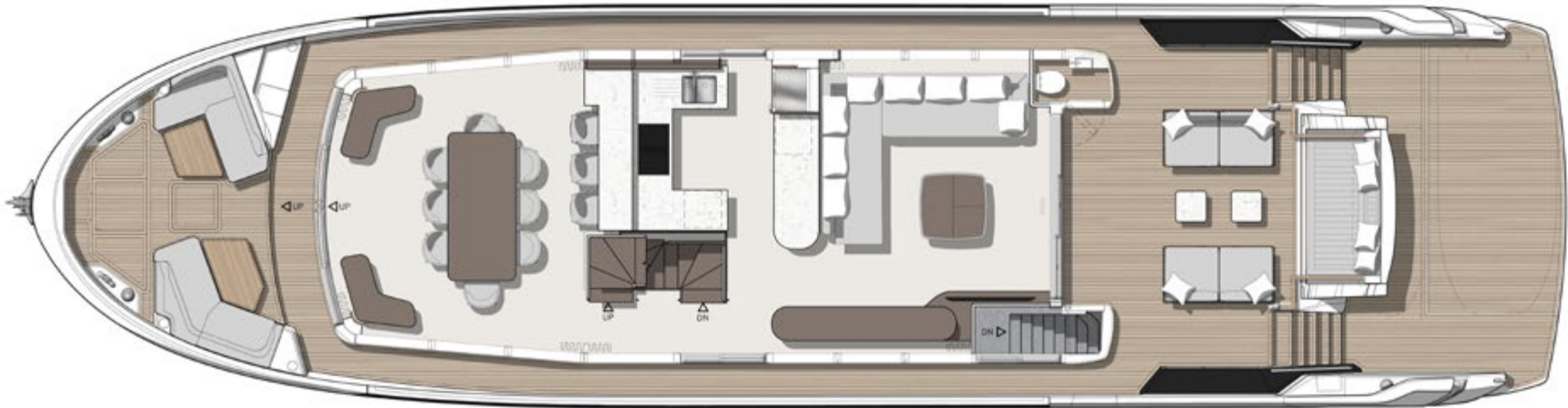

SHOWN WITH
OPTIONAL
TWIN ANCHOR
ARRANGEMENT,
FORWARD PATIO
DOOR, MAIN
DECK STATEROOM
ARRANGEMENT
GALLEY SIDE DECK
DOOR, DAYHEAD AND
SUNSEEKER X-TEND™
TRANSFORMER
SUNBEAD
ARRANGEMENT



MAIN DECK OPTIONS

OCEAN 156

GENERAL ARRANGEMENTS



LOWER DECK



90 OCEAN



90 OCEAN

The award-winning 90 Ocean will surprise and delight owners and guests alike. Every carefully considered detail elevates its sense of superiority beyond all expectations courtesy of wide open-plan spaces which evoke an impressive penthouse-style. A stem bow and broad beam immediately signal its ambitious intentions with a vast flybridge and an enhanced new Beach Club complete with Sunseeker X-TEND™ seating, bringing guests closer to the water than ever before.





PRINCIPAL CHARACTERISTICS

LENGTH OVERALL
27.10M / 88' 11"

BEAM
7.16M / 23' 6"

DRAFT
1.94 M / 6' 4"

DISPLACEMENT
82,300 KG / 181,440 LB

FUEL CAPACITY
13,000 LITRES / 3,434 US GAL.

FRESH WATER CAPACITY
1,500 LITRES / 400 US GAL.

BLACK WATER CAPACITY
800 LITRES / 211 US GAL.

GREY WATER CAPACITY
1,250 LITRES / 300 US GAL.

ACCOMMODATION
UP TO 10 GUESTS & UP TO 4
CREW

ENGINE OPTIONS
MAN UP TO 3,800 PS

MAXIMUM SPEED
27 KNOTS

RANGE @ 10/12 KNOTS
UP TO 1,900 NAUTICAL MILES

DRIVES
SHAFTS













90 OCEAN GENERAL ARRANGEMENTS

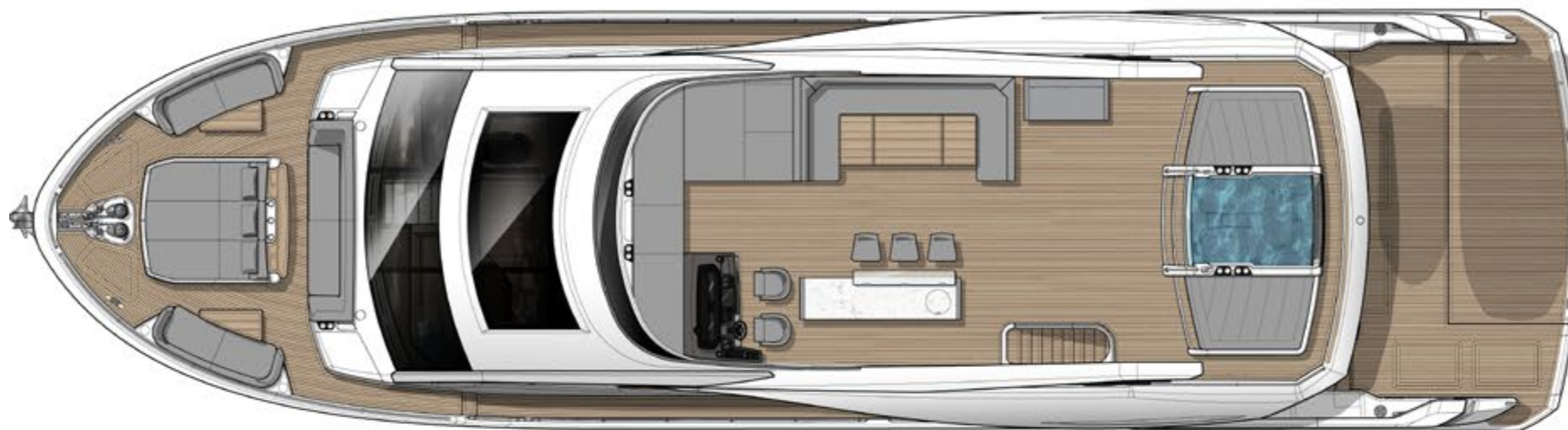
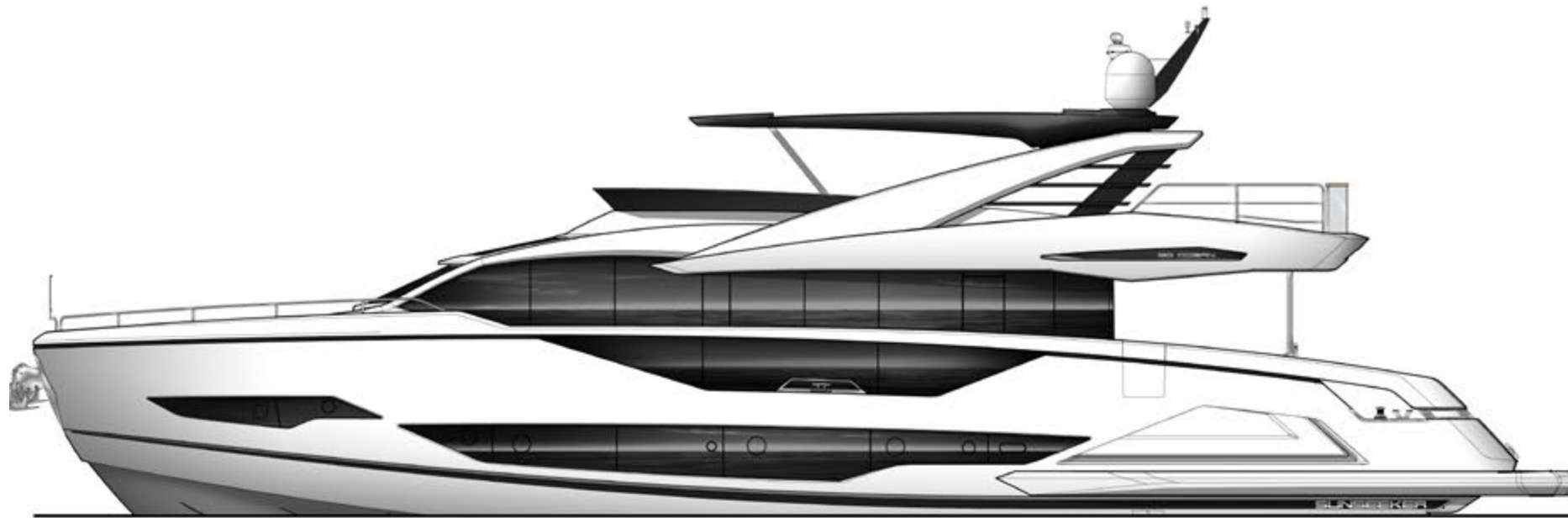

PROFILE AND FLYBRIDGE

© 2015 Sunseeker International Ltd. All Rights Reserved. 10/15

90 OCEAN GENERAL ARRANGEMENTS



MAIN DECK SALOON
SHOWN WITH EXTENDED SOFA SEATING, GALLEY
BAR WITH STOOLS AND PORT SIDE DINING

MAIN DECK AND OPTION

90 OCEAN GENERAL ARRANGEMENTS



LOWER DECK



OCEAN 182



OCEAN 182

Majestic and practical, the Ocean 182 promises the very best in comfort for long-distance cruising and efficient performance. Social zones open to the elements and expansive inside spaces offer the best of both worlds.





PRINCIPAL CHARACTERISTICS

LENGTH OVERALL
27.10M / 88' 11"

BEAM
7.16M / 23' 6"

DRAFT
1.94 M / 6' 4"

DISPLACEMENT
82,300 KG / 181,440 LB

FUEL CAPACITY
13,000 LITRES / 3,434 US GAL.

FRESH WATER CAPACITY
1,500 LITRES / 400 US GAL.

BLACK WATER CAPACITY
800 LITRES / 211 US GAL.

GREY WATER CAPACITY
1,250 LITRES / 300 US GAL.

ACCOMMODATION
UP TO 10 GUESTS & UP TO 4
CREW

ENGINE OPTIONS
MTU UP TO 3,800 PS

MAXIMUM SPEED
27 KNOTS

RANGE @ 10/12 KNOTS
UP TO 1,900 NAUTICAL MILES

DRIVES
SHAFTS









OCEAN 182
GENERAL ARRANGEMENTS



PROFILE

OCEAN 182

GENERAL ARRANGEMENTS

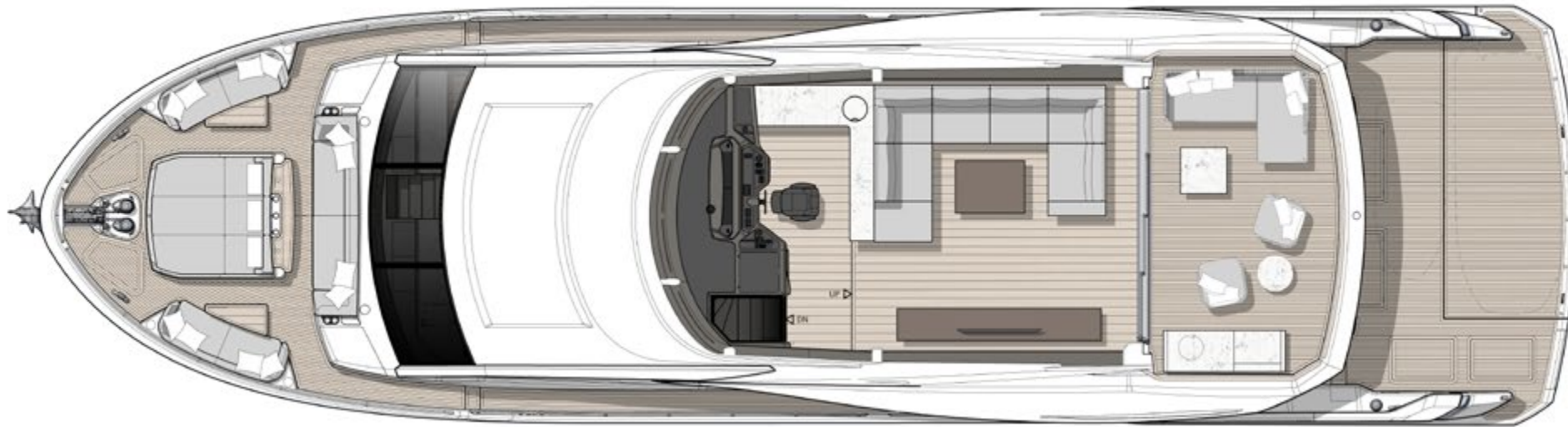

UPPER DECK

OCEAN 182

GENERAL ARRANGEMENTS

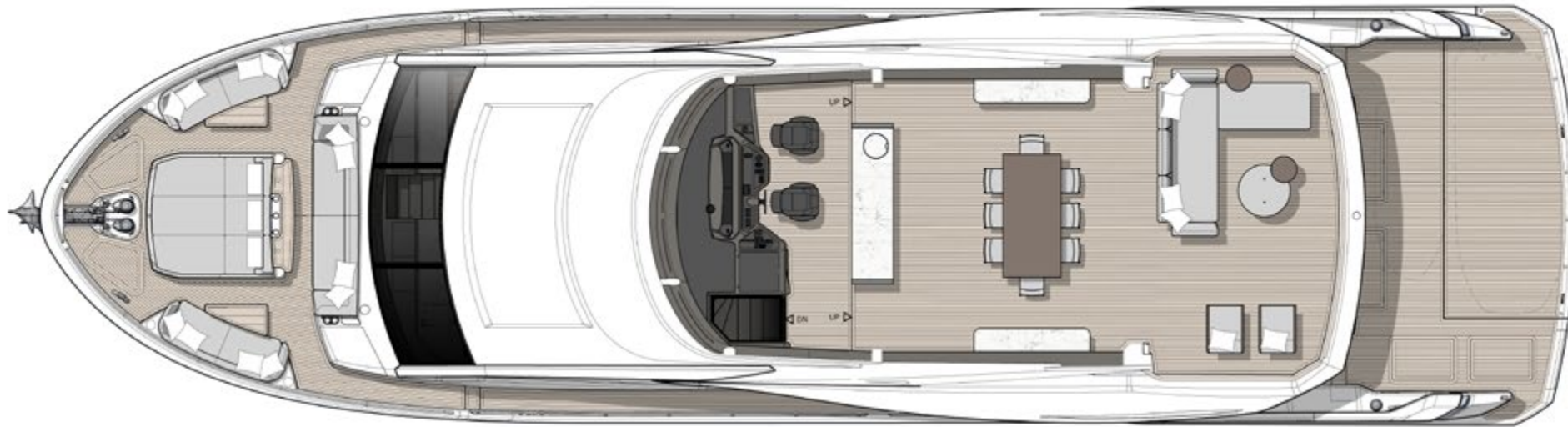

UPPER DECK OPTION
SHOWN WITH OPTIONAL DINING ARRANGEMENT AND AFT SEATING ARRANGEMENT

OCEAN 182 GENERAL ARRANGEMENTS

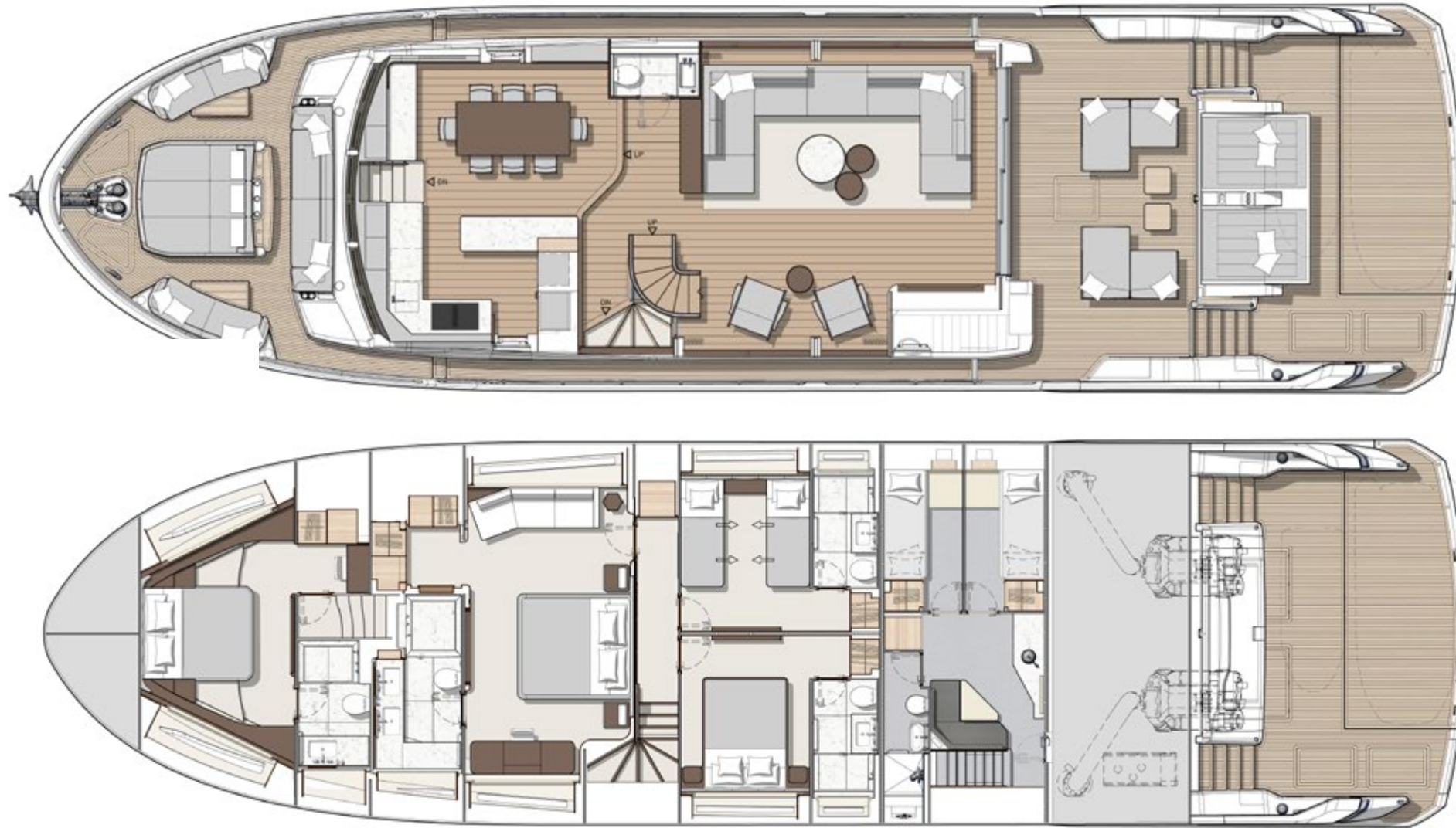

MAIN AND LOWER DECK



OCEAN 460



OCEAN 460

A captivating presence. The Ocean 460 redefines what it means to own a superyacht. An art form on the water, each zone has been considered to the finest detail. A private oasis awaits.





PRINCIPAL CHARACTERISTICS

LENGTH OVERALL
42.0M / 137' 10"

BEAM
9.50M / 31' 0"

DRAFT
2.70 M / 8' 10"

DISPLACEMENT @ HALF LOAD
220,000 KG / 485,017 LB

FUEL CAPACITY (STANDARD)
24,600 LITRES / 6,499 US GAL.

TOTAL LONG RANGE CAPACITY
(WITH OPTIONAL TANK)
30,000 LITRES / 7,926 US GAL.

FRESH WATER CAPACITY
6,500 LITRES / 1,717 US GAL.

BLACK WATER CAPACITY
2,000 LITRES / 528 US GAL.

GREY WATER CAPACITY
2,500 LITRES / 660 US GAL.

ACCOMMODATION
UP TO 12 GUESTS & UP TO 9 CREW

ENGINE OPTIONS
MTU UP TO 5,280 PS

MAXIMUM SPEED
UP TO 21 KNOTS

RANGE @ 10-12 KNOTS
UP TO 3,200 NAUTICAL MILES

DRIVES
SHAFTS

GROSS TONNAGE
460GT









OCEAN 460

GENERAL ARRANGEMENTS

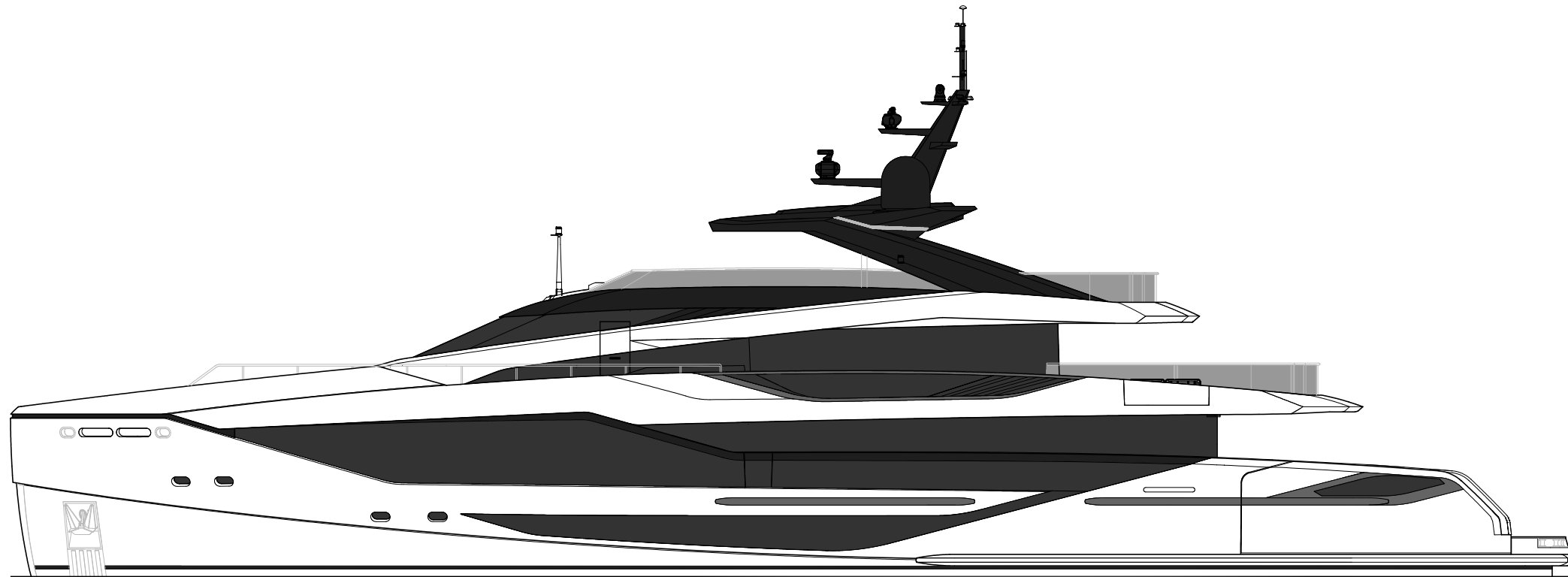

PROFILE

OCEAN 460

GENERAL ARRANGEMENTS

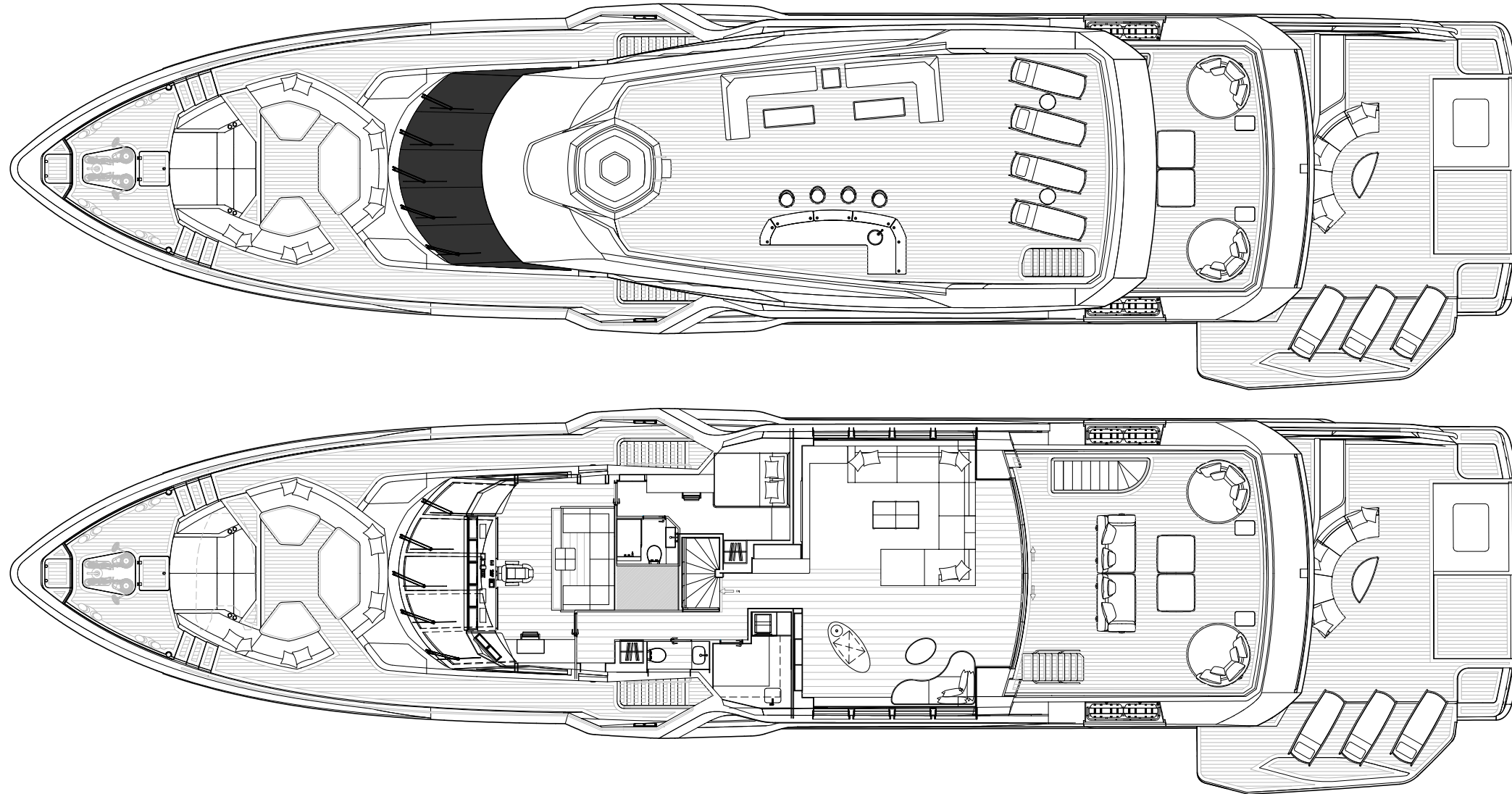

SKY AND UPPER DECK

OCEAN 460

GENERAL ARRANGEMENTS

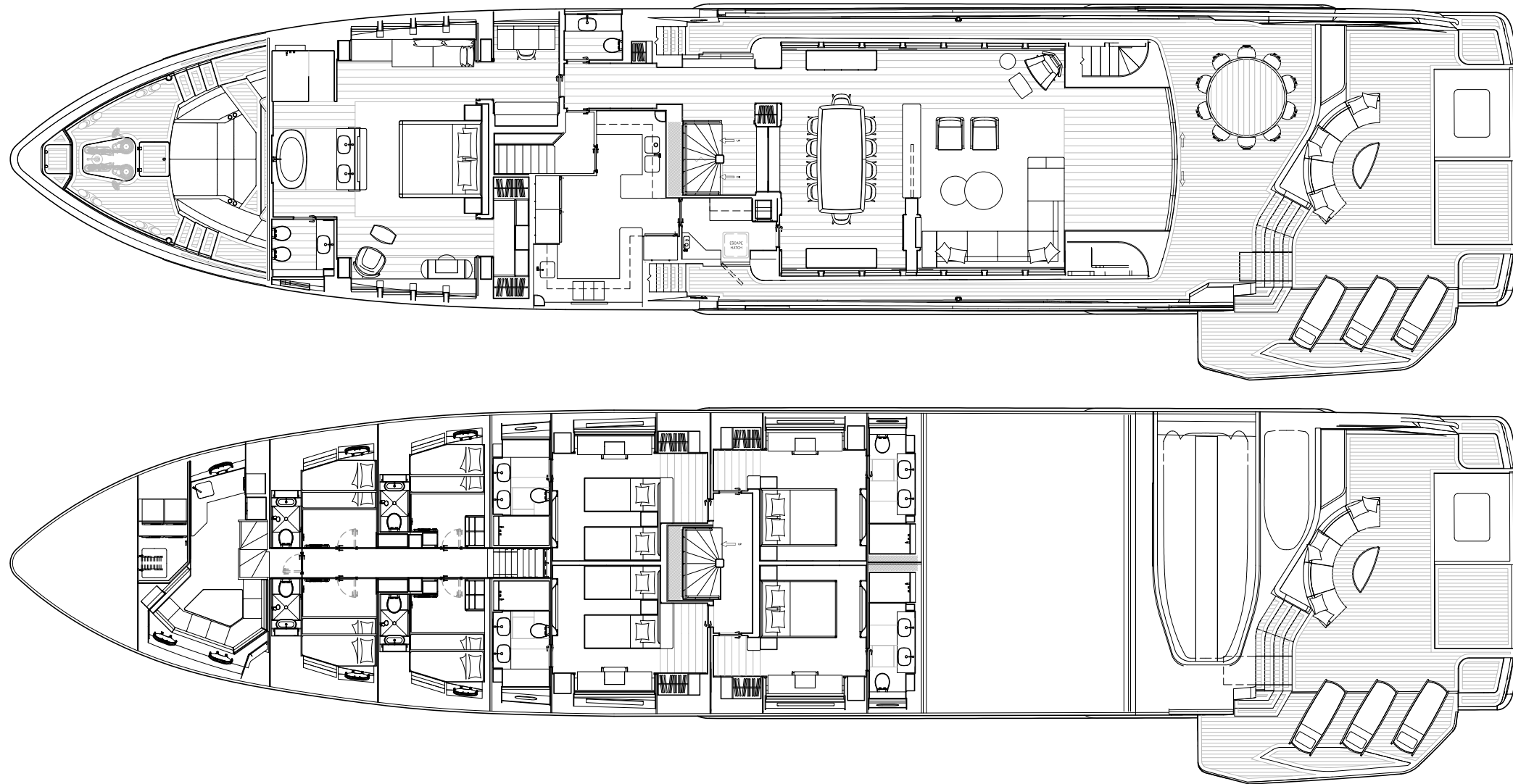

MAIN AND LOWER DECK



50M OCEAN



50M OCEAN

With its fast-displacement aluminium hull and superstructure, the new tri-deck 50M Ocean, heralds in a dawn for Sunseeker. With iconic exterior lines and compelling features, including plunge pool on the main deck and Beach Club with drop down bulwarks; these are the opulent signatures of usually much larger craft.





PRINCIPAL CHARACTERISTICS

LENGTH OVERALL
48.35M / 158' 8"

BEAM
8.55M / 28' 1"

DRAFT
2.1 M / 6' 10"

DISPLACEMENT
340,000 KG / 749,572 LB

FUEL CAPACITY (STANDARD)
45,000 LITRES / 11,887 US GAL.

FRESH WATER CAPACITY
20,800 LITRES / 5,495 US GAL.

BLACK WATER CAPACITY
3,000 LITRES / 793 US GAL.

GREY WATER CAPACITY
9,700 LITRES / 2,562 US GAL.

ACCOMMODATION
UP TO 10 GUESTS & UP TO 9
CREW

ENGINE OPTIONS
MTU UP TO 5,280 PS

MAXIMUM SPEED
UP TO 20.5 KNOTS

RANGE @ 12 KNOTS
UP TO 3,200 NAUTICAL MILES

DRIVES
SHAFTS

GROSS TONNAGE
499GT









50 M OCEAN
GENERAL ARRANGEMENTS



PROFILE

50M OCEAN GENERAL ARRANGEMENTS

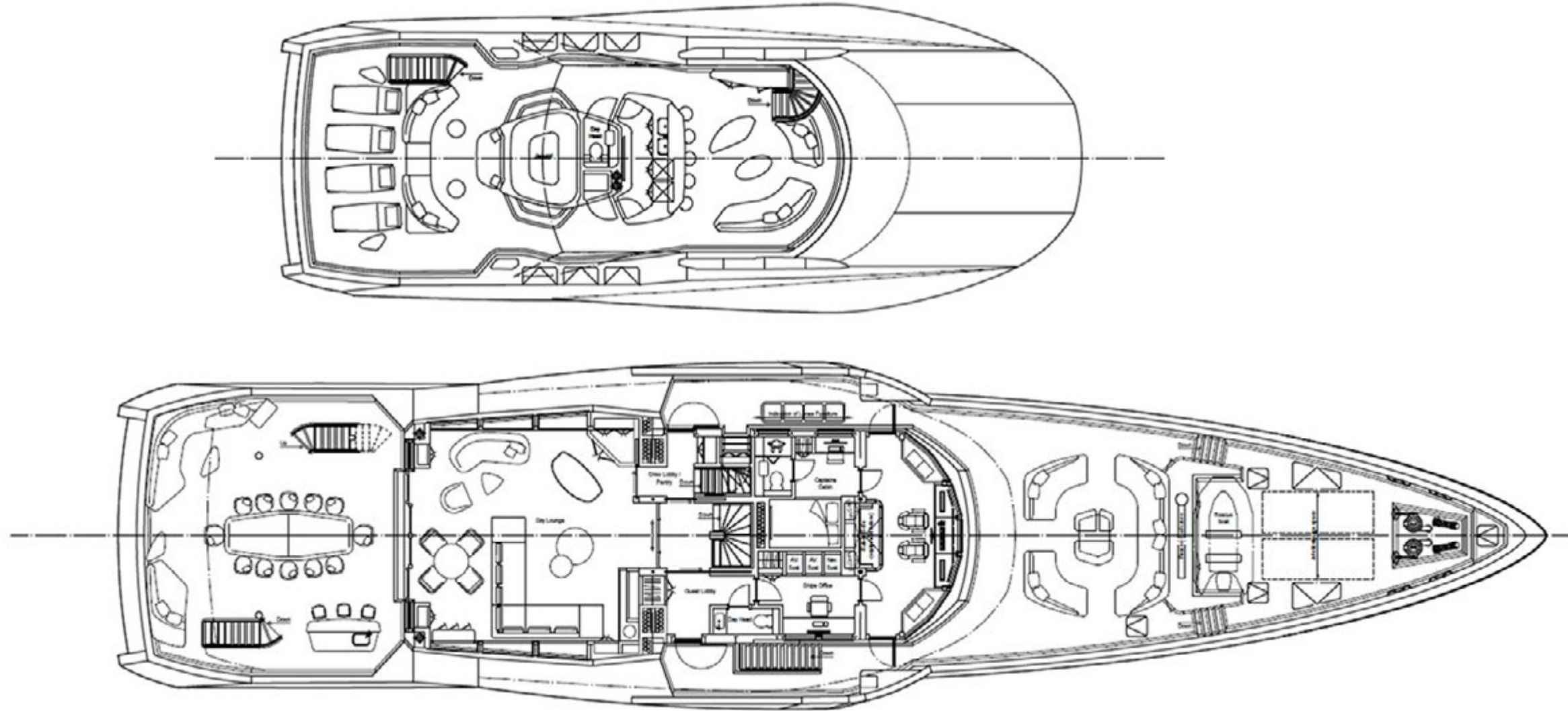

SUN AND WHEELHOUSE DECK

The image displays two detailed architectural floor plans of a ship, oriented vertically. The top plan represents the upper deck, featuring a large Main Salon with a circular area, a Main Kitchen, and a Main Cabin. The bottom plan represents the lower deck, showing the Engine Room, Fuel Tank, and various crew quarters. Both plans include numerous labels for specific rooms and equipment, such as 'Main Salon', 'Main Kitchen', 'Main Cabin', 'Engine Room', 'Fuel Tank', 'Crew Quarters', 'Galley', 'Staircase', 'Hatch', 'Vent', 'Door', 'Window', 'Table', 'Chair', 'Sofa', 'Bed', 'Bath', 'Toilet', 'Shower', 'Sink', 'Stove', 'Refrigerator', 'Freezer', 'Chest', 'Dresser', 'Desk', 'Chair', 'Table', 'Lamp', 'Mirror', 'TV', 'Radio', 'Phone', 'Clock', 'Calendar', 'Map', 'Compass', 'Chart', 'Log', 'Journal', 'Album', 'Box', 'Trunk', 'Suitcase', 'Bag', 'Case', 'Container', 'Vessel', 'Craft', 'Tool', 'Instrument', 'Machine', 'Device', 'Appliance', 'Furniture', 'Fixtures', 'Fittings', 'Hardware', 'Electronics', 'Plumbing', 'HVAC', 'Structural', 'Mechanical', 'Electrical', 'Communication', 'Navigation', 'Safety', 'Security', 'Maintenance', 'Repair', 'Storage', 'Inventory', 'Records', 'Documents', 'Files', 'Books', 'Papers', 'Forms', 'Tables', 'Charts', 'Maps', 'Plans', 'Drawings', 'Sketches', 'Photographs', 'Videos', 'Audio', 'Visual', 'Tactile', 'Olfactory', 'Gustatory', 'Auditory', 'Visual', 'Tactile', 'Olfactory', 'Gustatory', 'Auditory'.

MAIN AND LOWER DECK



SUPERYACHT



116 YACHT



116 YACHT

The 116 Yacht epitomises style and sophistication. Built for luxurious entertaining, whether it's the dedicated living and dining areas, enlarged foredeck, spacious flybridge framed by dramatic floor-to-ceiling windows, the full-beam master cabin or bespoke spa bath configuration. The 116 Yacht delivers the ultimate owner experience.





PRINCIPAL
CHARACTERISTICS

LENGTH OVERALL
35.20M / 115' 6"

BEAM
7.33M / 24' 0"

DRAFT
2.44 M / 8' 0"

DISPLACEMENT
140,000 KG / 308,000 LB

FUEL CAPACITY (STANDARD)
14,450 LITRES / 3,817 US GAL.

TOTAL LONG RANGE CAPACITY
(WITH OPTIONAL TANK)
19,400 LITRES / 5,124 US GAL.

FRESH WATER CAPACITY
4,000 LITRES / 1,055 US GAL.

BLACK WATER CAPACITY
1,340 LITRES / 355 US GAL.

GREY WATER CAPACITY
1,225 LITRES / 330 US GAL.

ACCOMMODATION
UP TO 12 GUESTS & UP TO 5 CREW

ENGINE OPTIONS
MTU UP TO 5,280 PS

MAXIMUM SPEED
UP TO 26 KNOTS

RANGE @ 12 KNOTS
UP TO 1,500 NAUTICAL MILES

DRIVES
SHAFTS

GROSS TONNAGE
220GT



LOST BOYS











116 YACHT GENERAL ARRANGEMENTS



PROFILE

116 YACHT
GENERAL ARRANGEMENTS

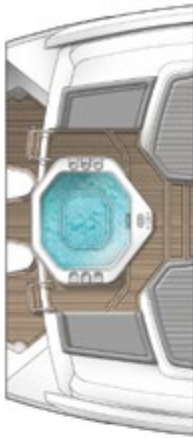
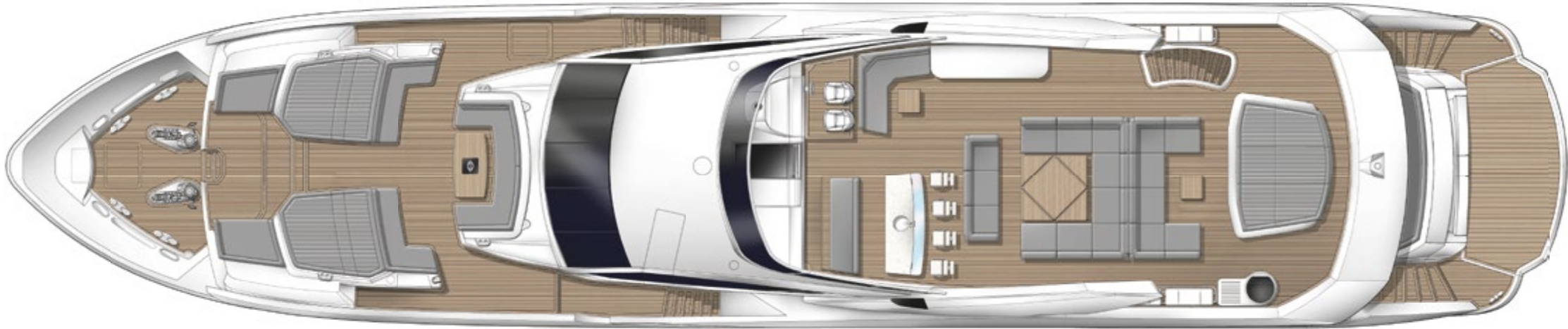

FOREDECK OPTION
SHOWN WITH
SPA TUB



WHEELHOUSE

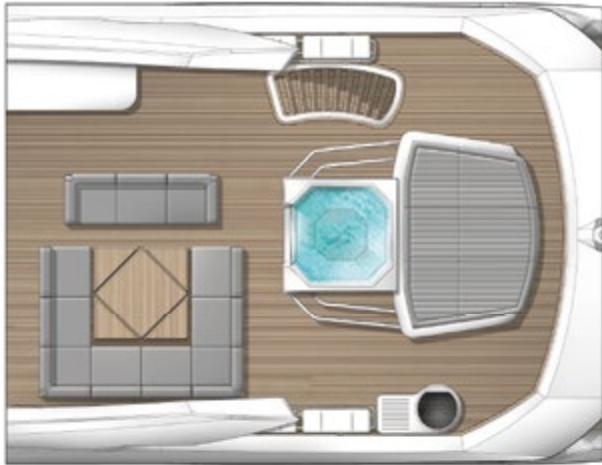

FLYBRIDGE OPTION
SHOWN WITH SPA TUB AND
SUNPAD ARRANGEMENT

FLYBRIDGE AND OPTIONS

116 YACHT GENERAL ARRANGEMENTS



MAIN AND LOWER DECK



131 YACHT



131 YACHT

The tri-deck 131 Yacht has a unique exterior profile and stunning interior space, it's one of the finest examples of modern-day superyacht design and craftsmanship. With seemingly endless layout options and opportunities to personalise at almost every turn, the opulent 131 Yacht is your very own private island.





PRINCIPAL CHARACTERISTICS

LENGTH OVERALL
40.05M / 131' 5"

BEAM
8.09M / 26' 7"

DRAFT
2.85 M / 9' 4"

DISPLACEMENT
189,600 KG / 417,996 LB

FUEL CAPACITY (STANDARD)
21,650 LITRES / 5,715 US GAL.

TOTAL LONG RANGE CAPACITY
(WITH OPTIONAL TANK)
26,700 LITRES / 7,050 US GAL.

FRESH WATER CAPACITY
4,950 LITRES / 1,307 US GAL.

BLACK WATER CAPACITY
1,450 LITRES / 383 US GAL.

GREY WATER CAPACITY
1,350 LITRES / 356 US GAL.

ACCOMMODATION
UP TO 12 GUESTS & UP TO 9 CREW

ENGINE OPTIONS
MTU UP TO 6,362 PS

MAXIMUM SPEED
UP TO 25 KNOTS

RANGE @ 12 KNOTS
UP TO 1,600 NAUTICAL MILES

DRIVES
SHAFTS











131 YACHT GENERAL ARRANGEMENTS



PROFILE

131 YACHT GENERAL ARRANGEMENTS



SKY AND UPPER DECK

131 YACHT GENERAL ARRANGEMENTS



MAIN AND LOWER DECK



Whilst every effort has been made to provide accurate information, the content of this e-brochure is not intended to be, and should not be relied upon as providing, any warranty, representation, guarantee, or offer. Performance and range figures are estimates to be used as an indicative guide only and are not guaranteed. Dirt or marine growth on the hull, size of boat, engine choice and tuning, propeller condition and pitch, air and water temperature, fuel weight and quality, water weight, stores, number of people on board and other factors can each affect a boat's performance and range. The photographs and artist's impressions in this e-brochure are from existing models in the Sunseeker range. There may be items shown in these photographs and impressions that are not included in the standard inventory of the models shown. Specifications, measurements and certain other details contained in this e-brochure may relate to models only for sale in a particular territory. We cannot guarantee that the entire Sunseeker range will be available in every territory. Specifications for models sold in different territories may also vary. Specifications may be changed or models withdrawn at any time without prior notice. The individual specification for each vessel will be agreed as part of the order process and confirmed in the sales contract between the purchaser and the approved Sunseeker distributor or dealer in the relevant territory. Please contact the local Sunseeker distributor or dealer in the territory which is of interest to you, to enquire as to the models and options that are likely to be available in that territory. This e-brochure is created and published in the United Kingdom by or on behalf of Sunseeker International Ltd and subject to the limitations and exclusions set out herein provides information relating to new Sunseeker™ manufactured motor yachts sold outside of the United States of America and Canada. For parties requiring information on new Sunseeker models for sale in the United States or Canada please contact a Sunseeker USA Sales Co. Inc. appointed dealer in the relevant territory. All distributors and dealers of new Sunseeker manufactured motor yachts are independently owned and controlled businesses. They are not subsidiaries of, or agents for, Sunseeker International Limited, Sunseeker USA Sales Co. Inc. or any of their respective parent, subsidiary or affiliated companies. As such, no distributor or dealer has any authority to bind or obligate any Sunseeker company in any way unless first agreed in writing signed by an authorized Sunseeker signatory.

Information about how we use personal data is set out in our Privacy Policy at <https://www.sunseeker.com/legal>